

FITTINGS

TS11-EN 10242



Temper Dökme Demir fittingler

Product range

| | | | | | |
|---|---|---|---|--|---|
| 1 | 1a | 2 | 2a | 3 | 40 |
|  |  |  |  |  |  |
| 41 | 85 | 87 | 90 | 90DT | 90R |
|  |  |  |  |  |  |
| 92 | 92R | 95 | 96 | 97 | 98 |
|  |  |  |  |  |  |
| 120 | 121 | 130 | 130R | 131 | 180 |
|  |  |  |  |  |  |
| 180R | 240 | 241 | 245 | 246 | 270 |
|  |  |  |  |  |  |
| 270DT | 271 | 280 | 290 | 291 | 300 |
|  |  |  |  |  |  |
| 310 | 330 | 331 | 340 | 341 | 370 |
|  |  |  |  |  |  |
| 371 | 372 | 374 | 529a | 330 SB | 330 PB |
|  |  |  |  |  |  |

Dişli Boru Bağlantı Parçaları (Fittingler)

Ürün standartları: TS-EN 10242

Trakya Döküm temper dökme demir fittingleri, Avrupa temper dökme demir fitting standardı EN 10242 Dizayn sembolü "A" ve uluslararası fitting standardı ISO 49 normlarına uygun olarak üretilmektedir.

Her iki standartta temper dökme demirden imal edilen dişli boru fittinglerin sahip olması gereken dizayn ve performans kriterlerini tanımlamaktadır.

Trakya Döküm fittingleri her iki standardın tüm gerekliliklerini yerine getirecek şekilde ve aşağıda belirtilen basınç ve sıcaklık limitlerinde tüm akışkan ve gazların (hava, su doğal gaz, sıvı yakıtlar vs.) taşınmasına uygun olarak üretilmektedir.

a) Normal uygulamalar

a1) Minimum çalışma sıcaklığı -20°C.

Minimum çalışma sıcaklığındaki basınç 25 bar.

a2) -20°C - 120°C sıcaklık aralığında maksimum çalışma basıncı 25 bar.

a3) 120°C - 300°C sıcaklık aralığında maksimum çalışma basıncı 25 - 20 bar aralığında. (Grafik 1)

b) Özel uygulamalar

-20°C'nin altındaki özel uygulamalar veya normal uygulamalar dışındaki diğer uygulamalar için Trakya Döküm'e danışılmalıdır.

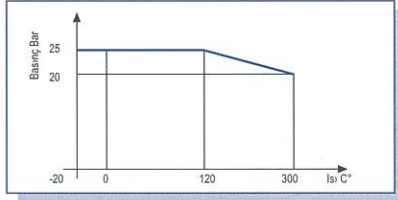

Grafik 1 : Basınç - sıcaklık ilişkisi
Nota : 1 bar = 10⁵ N/m² = 100kPa

Teknik spesifikasyonlar

Malzeme

Trakya Döküm fittingleri, EN 10242:1994 standardının "A" dizayn sembolüne uygun olarak siyah temper dökme malzemeden EN-GJMB-350-10 malzeme standardına uygun olarak üretilmektedir.

Dişler

Trakya Döküm fittinglerinin dişleri ISO 7-1 normlarında belirtilen diş ölçülerine uygun olacak şekilde iç dişler paralel (Rp) ve dış dişler 1/16 konik (R) olarak imal edilmektedir.

ISO 228/1 standardına uygun dişler G ile sembolize edilmiştir.

Nominal çap ve bağlantı ölçüleri

| mm | 6 | 8 | 10 | 15 | 20 | 25 | 32 | 40 | 50 | 65 | 80 | 100 |
|----|-----|-----|-----|-----|-----|----|-------|-------|----|-------|----|-----|
| " | 1/8 | 1/4 | 3/8 | 1/2 | 3/4 | 1 | 1 1/4 | 1 1/2 | 2 | 2 1/2 | 3 | 4 |

Yüzey Kaplama

Trakya Döküm fittingleri siyah veya daldırma galvaniz ile kaplanmış olarak ve korozyona açık yüzeylerin korunması amacı ile koruyucuyla kaplanmış şekilde kullanıma sunulmaktadır.

Galvanizli fittingler EN 10242:1994 standardına uygun olarak sıcak daldırma metodu ile minimum yüzey kaplama yoğunluğu 500gr/m²

ve minimum kaplama kalınlığı 70 µm olacak şekilde galvaniz ile kaplanmaktadır. Yüzey kaplamada kullanılan çinkonun saflığı nedeni ile Td fittingleri içme suyu uygulamaları için özellikle tavsiye edilmektedir.

Boyutlar

Fittinglere ait boyutlar katalogta mevcuttur. Verilen boyutlar nominal değerlerdir.

Ölçü tanımlaması

Fittinglerin tanımlanması en basit fittingler ile başlar ve bazı temel özellikler ile belirtilir.

Ölçülerin sıralamasında aşağıda belirtilen basit kural dizisi uygulanmıştır.

- Eşit çıkışlı fittingler için tek bir bağlantı ölçüsü vermek yeterlidir.
- İki farklı ölçüye sahip redüksiyon fittingler, önce büyük olan, daha sonra küçük ölçünün belirtilmesi ile tanımlanır.
- Üç ya da daha fazla bağlantıya sahip fittingler için (Resim 1 ve 4) önce girişin ölçüsü verilir, giriş ve çıkış ölçülerinin eşit olması durumunda, bunu dalın ölçüsü takip eder.
- Daralan bir çıkışın olduğu 3 çıkışlı fittinglerin ölçüleri 2 ve 3 no'lu resimlerde belirtilen sıra ile tanımlanır.

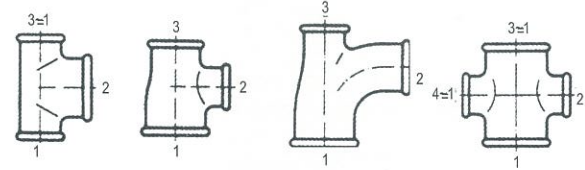

Ağırlık Bilgisi

Bu katalogdaki indeks ve parça ağırlık değerleri sadece genel bilgi için verilmiştir. Verilen parça ağırlıkları nominal değerler olup, teknik sebeplerden dolayı parça ağırlıklarında farklılıklar olabilir.

Düz Rakor

Düz rakorlar contasız olarak tedarik edilir. Göbekten dışa doğru sökülebilir ve tekrar biraraya getirilebilir.

Sızdırmazlık

Sızdırmazlık için halkalı rakorların yatakları kullanılmadan önce temizlenmeli ve yağlanmalıdır. İçme suyu uygulamalarında ise, içme suyunda kullanıma uygun dış sızdırmazlık malzemesi ile (örneğin DIN 3066'a uygun dış sızdırmazlık pastası ile) temizlenmeli ve yağlanmalıdır.

Kısaltmalar ve Tanımlar

| | |
|-------|---|
| SYH | Siyah |
| GAL | Galvanizli |
| * | Çelikten yapılan (yüzey kaplama=elektro galvaniz) ve içme suyunda kullanılmaya uygun olmayan fittingler. |
| KOD | Td parça numarası |
| ISO | ISO 49 |
| Gr | Parça ağırlığı |
| G | Bağlama dişleri sızdırmazlığı ISO 228 standardında belirtildiği gibi montaj yapılan dişler arasında sağlanamaz. |
| Fiyat | YTL/adet |

Sipariş Bilgileri

Td temper döküm fittingsleri (Dizayn Sembolü "A") aşağıdaki detaylar verilerek sipariş edilmelidir.

1. Td kodu
2. Miktar

Introduction

Trakya Dokum, with its modern production facilities and experienced personnel, is the leading malleable cast iron fitting manufacturer in Turkey, producing fittings compliant with EN 10242 Design Symbol "A". High quality malleable cast iron fittings have been manufactured by Trakya Dokum since 1982 using modern machinery and equipment.

The fittings production line is equipped with a Disamatic 2013 Mk 4, Junker Presspour and main frequency melting furnaces. Special care has been taken to select modern sophisticated technology from Western Europe and the USA in all sections of sand preparation, core-making, fettling, heat treatment, galvanising, thread-cutting, laboratories and pattern-making, enabling the company to produce superior cast iron fittings for sales all around the world.

Product standards

Td malleable cast iron fittings are in accordance with the current ISO 49 and EN 10242 standards and are designated with the design symbol A.

Threads

Basic fitting threads are jointing threads, where ISO 7-1 applies. Internal threads are parallel (Rp) and external threads are 1:16 taper (R). Threads, which are fastening threads according to ISO 228/1, are marked with G on the symbol picture.

Surface finish

Our Td malleable cast iron fittings are provided in black or hot dip galvanized finish, covered with a preservative for temporary prevention of rust film. Td fittings can be delivered in black or galvanized finish as requested by the purchaser. As prescribed by the standard EN 10242, the mass of zinc coating shall not be less than 500gr/m² which corresponds to a medium layer thickness of 70 µm.

"Fittings marked with (*) are exceptions. They are made of steel and if a galvanized finish is required for these fittings, it can only be possible through electroplating for technical reasons"

Dimensions

All dimensions, z-dimensions and other technical data can be found in the catalogue.

Size designation

The naming of fitting types starts with the most basic type definition and some basic features follow that. As far as the sequence of connection sizes are concerned, the following simple set of rules applies.

- For equal fittings, individual connection size is sufficient
- For reducing fittings with 2 connections of different sizes, the connection size of the larger connection is given first, followed by the smaller connection.
- For fittings with 3 or more connections (illustrations 1 and 4), the throughput size is given first, and in the case of equal connections on the run, it is followed by the size of the branch.
- For 3 different connections or sections reduced in the run, the sequence for the designation of connections is according to illustrations 2 and 3.

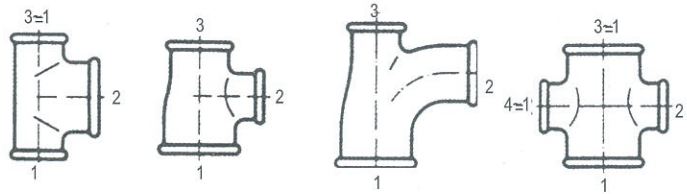

Weight information

The weight values given in this catalogue are "nominal values". Differences in weight can occur in cast iron products for technical reasons.

Flat seat unions

Flat seat unions are supplied without gaskets. They can be dismantled (radially) and re-assembled.

Unions with metallic sealing

Seats of metallic sealing unions must be cleaned and greased before use. For potable water applications, they should be cleaned and lubricated with a potable water approved thread sealant (e.g. thread sealing paste complying to DIN 30660.)

Quality testing/ leak test

Applying the standard EN 10242, each individual Td fitting is subjected to a pressure test with a minimum hydrostatic pressure of 20 bar, which is equivalent to a pneumatic pressure of minimum 5 bar.

Key

| | |
|--------|---|
| BLK | Black |
| GAL | Galvanized |
| * | Types of fittings that are made of steel (galvanized finish = electro-plated) and unsuitable for potable water installations. |
| Code | Td part number |
| ISO | Designates ISO 49 |
| Bag | Quantity per standard pack |
| Carton | Quantity per carton |
| Gr | ~ Piece weight in grams |
| G | Fastening thread not sealing in the joint as defined by ISO 228. |

Ordering information

Td malleable cast iron fittings (Design Symbol A) should be ordered giving the following details :

1. Td code
2. Quantity

If it is not convenient to use the coding system, Td malleable cast iron fittings can also be ordered using individual feature definitions, as shown below:

According to standard:

Elbow EN 10242 – A1 – 2 Zn – A

| | |
|-------------------|------------------------------------|
| Elbow | type of fitting |
| EN 10242 (ISO 49) | standard |
| A1 | symbol |
| 2 | fitting size |
| Zn | surface finish hot dip zinc coated |
| A | Design Symbol |

Trakya Döküm katalog numaraları ve ISO/EN sembollerinin eşleştirilmesi
Correlation Trakya Döküm catalogue number - ISO/EN symbol

| Trakya Döküm | ISO/EN | Trakya Döküm | ISO/EN |
|--------------|----------------|--------------|--------|
| 1 | G4 | 245 | N8 red |
| 1a | D4 | 246 | M4 red |
| 2 | G1 | 270 | M2 |
| 2a | D1 | 271 | M2 R-L |
| 3 | G8 | 280 | N8 |
| 40 | G4/45 ∞ | 290 | T9 |
| 41 | G1/45 ∞ | 291 | T8 |
| 85 | | 300 | T1 |
| 87 | | 310 | P4 |
| 90 | A1 | 330 | U1 |
| 90R | A1 | 331 | U2 |
| 92 | A4 | 340 | U11 |
| 92R | A4 | 341 | U12 |
| 95 | UA1 | 370 | |
| 96 | UA11 | 371 | |
| 97 | UA2 | 372 | |
| 98 | UA12 | 374 | |
| 120 | A1/45 ∞ | 529a | M4 |
| 121 | A4/45 ∞ | | |
| 130 | B1 | | |
| 130R | B1 | | |
| 131 | E1 | | |
| 180 | C1 | | |
| 180R | C1 | | |
| 240 | M2 red | | |
| 241 | N4 | | |

Trakya Döküm katalog numaralarına göre sıralama

Starting with Trakya Döküm Cat.Nr.

| ISO/EN | Trakya Döküm | ISO/EN | Trakya Döküm |
|----------------|--------------|--------|--------------|
| A1 | 90 | N8 | 280 |
| A1 | 90R | N8 red | 245 |
| A1/45 ∞ | 120 | P4 | 310 |
| A4 | 92 | T1 | 300 |
| A4 | 92R | T8 | 291 |
| A4/45 ∞ | 121 | T9 | 290 |
| B1 | 130 | U1 | 330 |
| B1 | 130R | U2 | 331 |
| C1 | 180 | U11 | 340 |
| C1 | 180R | U12 | 341 |
| D4 | 1a | UA1 | 95 |
| E1 | 131 | UA2 | 97 |
| G1 | 2 | UA11 | 96 |
| G1/45 ∞ | 41 | UA12 | 98 |
| G4 | 1 | | |
| G4/45 ∞ | 40 | | |
| G8 | 3 | | |
| M2 | 270 | | |
| M2 R-L | 271 | | |
| M2 red | 240 | | |
| M4 | 529a | | |
| M4 red | 246 | | |
| N4 | 241 | | |

ISO/EN sembollerine göre sıralama

Starting with ISO/EN symbols

Dönüşüm Tablosu (inç-mm)

Correlation of the inch and mm sizes

| Fitting Ölçüsü <i>Fitting size</i> | 1/8 | 1/4 | 3/8 | 1/2 | 3/4 | 1 | 1 1/4 | 1 1/2 | 2 | 2 1/2 | 3 | 4 |
|---|-----|-----|-----|-----|-----|----|-------|-------|----|-------|----|-----|
| Nominal Ölçü DN <i>Nominal size DN</i> | 6 | 8 | 10 | 15 | 20 | 25 | 32 | 40 | 50 | 65 | 80 | 100 |

1

ISO/EN (G4)

Deveboynu 90°
(İç ve Dış vidalı)

Long sweep bend

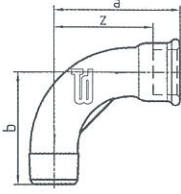

| | Ölçü Size | Kod Code | Poşet Bag | Kutu Carton | Gr Gr |
|--|--------------|-------------|--------------|----------------|----------|
| | SYH 1/2 | FS00010002 | 10 | 180 | 113 |
| | GLV 1/2 | FG00010002 | 10 | 180 | 119 |
| | SYH 3/4 | FS00010003 | 10 | 100 | 199 |
| | GLV 3/4 | FG00010003 | 10 | 100 | 211 |
| | SYH 1 | FS00010004 | | 60 | 319 |
| | GLV 1 | FG00010004 | | 60 | 350 |
| | SYH 1 1/4 | FS00010005 | | 30 | 520 |
| | GLV 1 1/4 | FG00010005 | | 30 | 557 |
| | SYH 1 1/2 | FS00010006 | | 25 | 684 |
| | GLV 1 1/2 | FG00010006 | | 25 | 722 |
| | SYH 2 | FS00010007 | | 12 | 1404 |
| | GLV 2 | FG00010007 | | 12 | 1496 |

| | Ölçü Size | Kod Code | a | b | z | z1 |
|--|--------------|-------------|-----|-----|-----|----|
| | SYH 1/2 | FS00010002 | 55 | 48 | 42 | |
| | GLV 1/2 | FG00010002 | | | | |
| | SYH 3/4 | FS00010003 | 69 | 60 | 54 | |
| | GLV 3/4 | FG00010003 | | | | |
| | SYH 1 | FS00010004 | 85 | 75 | 68 | |
| | GLV 1 | FG00010004 | | | | |
| | SYH 1 1/4 | FS00010005 | 105 | 95 | 86 | |
| | GLV 1 1/4 | FG00010005 | | | | |
| | SYH 1 1/2 | FS00010006 | 116 | 105 | 97 | |
| | GLV 1 1/2 | FG00010006 | | | | |
| | SYH 2 | FS00010007 | 140 | 130 | 116 | |
| | GLV 2 | FG00010007 | | | | |

1a

ISO/EN (D4)

Kısa Deveboynu
İç ve Dış Dişli

Short bend

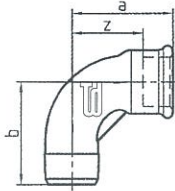

| | Ölçü Size | Kod Code | Poşet Bag | Kutu Carton | Gr Gr |
|--|--------------|-------------|--------------|----------------|----------|
| | SYH 1/2 | FS001A0002 | 10 | 180 | 120 |
| | GLV 1/2 | FG001A0002 | 10 | 180 | 125 |
| | SYH 3/4 | FS001A0003 | 10 | 100 | 200 |
| | GLV 3/4 | FG001A0003 | 10 | 100 | 205 |
| | SYH 1 | FS001A0004 | | 60 | 330 |
| | GLV 1 | FG001A0004 | | 60 | 350 |
| | SYH 1 1/4 | FS001A0005 | | 30 | 530 |
| | GLV 1 1/4 | FG001A0005 | | 30 | 550 |
| | SYH 1 1/2 | FS001A0006 | | 25 | 705 |
| | GLV 1 1/2 | FG001A0006 | | 25 | 730 |
| | SYH 2 | FS001A0007 | | 12 | 1285 |
| | GLV 2 | FG001A0007 | | 12 | 1335 |

| | Ölçü Size | Kod Code | a | b | z | z1 |
|--|--------------|-------------|-----|-----|----|----|
| | SYH 1/2 | FS001A0002 | 45 | 45 | 32 | |
| | GLV 1/2 | FG001A0002 | | | | |
| | SYH 3/4 | FS001A0003 | 50 | 50 | 35 | |
| | GLV 3/4 | FG001A0003 | | | | |
| | SYH 1 | FS001A0004 | 63 | 63 | 46 | |
| | GLV 1 | FG001A0004 | | | | |
| | SYH 1 1/4 | FS001A0005 | 76 | 76 | 57 | |
| | GLV 1 1/4 | FG001A0005 | | | | |
| | SYH 1 1/2 | FS001A0006 | 85 | 85 | 66 | |
| | GLV 1 1/2 | FG001A0006 | | | | |
| | SYH 2 | FS001A0007 | 102 | 102 | 78 | |
| | GLV 2 | FG001A0007 | | | | |

| | Ölçü Size | Kod Code | Poşet Bag | Kutu Carton | Gr Gr |
|-----|--------------|-------------|--------------|----------------|----------|
| SYH | 1/2 | FS00020002 | 10 | 160 | 136 |
| GLV | 1/2 | FG00020002 | 10 | 160 | 148 |
| SYH | 3/4 | FS00020003 | 10 | 80 | 253 |
| GLV | 3/4 | FG00020003 | 10 | 80 | 272 |
| SYH | 1 | FS00020004 | | 50 | 389 |
| GLV | 1 | FG00020004 | | 50 | 411 |
| SYH | 1 1/4 | FS00020005 | | 30 | 612 |
| GLV | 1 1/4 | FG00020005 | | 30 | 655 |
| SYH | 1 1/2 | FS00020006 | | 20 | 795 |
| GLV | 1 1/2 | FG00020006 | | 20 | 846 |
| SYH | 2 | FS00020007 | | 10 | 1519 |
| GLV | 2 | FG00020007 | | 10 | 1618 |

| | Ölçü Size | Kod Code | a | b | z | z1 |
|-----|--------------|-------------|-----|---|-----|----|
| SYH | 1/2 | FS00020002 | 55 | | 42 | |
| GLV | 1/2 | FG00020002 | | | | |
| SYH | 3/4 | FS00020003 | 69 | | 54 | |
| GLV | 3/4 | FG00020003 | | | | |
| SYH | 1 | FS00020004 | 85 | | 68 | |
| GLV | 1 | FG00020004 | | | | |
| SYH | 1 1/4 | FS00020005 | 105 | | 86 | |
| GLV | 1 1/4 | FG00020005 | | | | |
| SYH | 1 1/2 | FS00020006 | 116 | | 97 | |
| GLV | 1 1/2 | FG00020006 | | | | |
| SYH | 2 | FS00020007 | 140 | | 116 | |
| GLV | 2 | FG00020007 | | | | |



2
ISO/EN (G1)
90° Deveboynu
(İç vidalı)
Long sweep bend

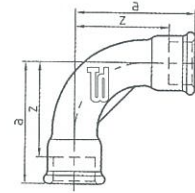

| | Ölçü Size | Kod Code | Poşet Bag | Kutu Carton | Gr Gr |
|-----|--------------|-------------|--------------|----------------|----------|
| SYH | 1/2 | FS002A0002 | 10 | 160 | 140 |
| GLV | 1/2 | FG002A0002 | 10 | 160 | 145 |
| SYH | 3/4 | FS002A0003 | 10 | 80 | 235 |
| GLV | 3/4 | FG002A0003 | 10 | 80 | 245 |
| SYH | 1 | FS002A0004 | | 50 | 385 |
| GLV | 1 | FG002A0004 | | 50 | 395 |
| SYH | 1 1/4 | FS002A0005 | | 30 | 645 |
| GLV | 1 1/4 | FG002A0005 | | 30 | 675 |
| SYH | 1 1/2 | FS002A0006 | | 20 | 830 |
| GLV | 1 1/2 | FG002A0006 | | 20 | 865 |
| SYH | 2 | FS002A0007 | | 10 | 1415 |
| GLV | 2 | FG002A0007 | | 10 | 1455 |
| SYH | 3 | FS002A0009 | | 4 | 2565 |
| GLV | 3 | FG002A0009 | | 4 | 2660 |

| | Ölçü Size | Kod Code | a | b | z | z1 |
|-----|--------------|-------------|-----|---|----|----|
| SYH | 1/2 | FS002A0002 | 45 | | 32 | |
| GLV | 1/2 | FG002A0002 | | | | |
| SYH | 3/4 | FS002A0003 | 50 | | 35 | |
| GLV | 3/4 | FG002A0003 | | | | |
| SYH | 1 | FS002A0004 | 63 | | 46 | |
| GLV | 1 | FG002A0004 | | | | |
| SYH | 1 1/4 | FS002A0005 | 76 | | 57 | |
| GLV | 1 1/4 | FG002A0005 | | | | |
| SYH | 1 1/2 | FS002A0006 | 85 | | 66 | |
| GLV | 1 1/2 | FG002A0006 | | | | |
| SYH | 2 | FS002A0007 | 102 | | 78 | |
| GLV | 2 | FG002A0007 | | | | |
| SYH | 3 | FS002A0009 | 127 | | 97 | |
| GLV | 3 | FG002A0009 | | | | |

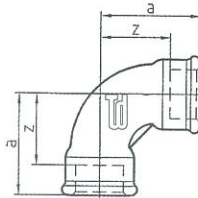

2a
ISO/EN (D1)
Kısa Deveboynu
(İç vidalı)
Short bend

3
ISO/EN (G8)

90° Deveboynu
(Dış vidalı)

Long sweep bend

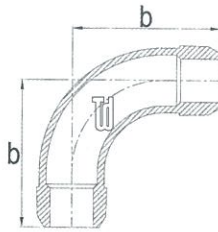

| Ölçü Size | Kod Code | Poşet Bag | Kutu Carton | Gr Gr |
|--------------|-------------|--------------|----------------|----------|
| SYH 1/2 | FS00030002 | 10 | 180 | 95 |
| GLV 1/2 | FG00030002 | 10 | 180 | 100 |
| SYH 3/4 | FS00030003 | 10 | 100 | 175 |
| GLV 3/4 | FG00030003 | 10 | 100 | 190 |
| SYH 1 | FS00030004 | | 60 | 340 |
| GLV 1 | FG00030004 | | 60 | 360 |
| SYH 1 1/4 | FS00030005 | | 30 | 540 |
| GLV 1 1/4 | FG00030005 | | 30 | 575 |
| SYH 1 1/2 | FS00030006 | | 25 | 740 |
| GLV 1 1/2 | FG00030006 | | 25 | 780 |
| SYH 2 | FS00030007 | | 12 | 1.400 |
| GLV 2 | FG00030007 | | 12 | 1.460 |

| Ölçü Size | Kod Code | a | b | z | z1 |
|--------------|-------------|---|-----|---|----|
| SYH 1/2 | FS00030002 | | 48 | | |
| GLV 1/2 | FG00030002 | | | | |
| SYH 3/4 | FS00030003 | | 60 | | |
| GLV 3/4 | FG00030003 | | | | |
| SYH 1 | FS00030004 | | 75 | | |
| GLV 1 | FG00030004 | | | | |
| SYH 1 1/4 | FS00030005 | | 95 | | |
| GLV 1 1/4 | FG00030005 | | | | |
| SYH 1 1/2 | FS00030006 | | 105 | | |
| GLV 1 1/2 | FG00030006 | | | | |
| SYH 2 | FS00030007 | | 130 | | |
| GLV 2 | FG00030007 | | | | |

40
ISO/EN (G4/45°)

45° Deveboynu
(İç ve dış vidalı)

45° Long sweep
bend

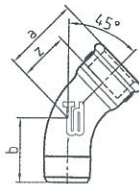

| Ölçü Size | Kod Code | Poşet Bag | Kutu Carton | Gr Gr |
|--------------|-------------|--------------|----------------|----------|
| SYH 1/2 | FS00400002 | 10 | 180 | 108 |
| GLV 1/2 | FG00400002 | 10 | 180 | 112 |
| SYH 3/4 | FS00400003 | 10 | 100 | 175 |
| GLV 3/4 | FG00400003 | 10 | 100 | 180 |
| SYH 1 | FS00400004 | 10 | 60 | 280 |
| GLV 1 | FG00400004 | 10 | 60 | 295 |
| SYH 1 1/4 | FS00400005 | | 30 | 575 |
| GLV 1 1/4 | FG00400005 | | 30 | 605 |
| SYH 1 1/2 | FS00400006 | | 25 | 620 |
| GLV 1 1/2 | FG00400006 | | 25 | 655 |
| SYH 2 | FS00400007 | | 12 | 1050 |
| GLV 2 | FG00400007 | | 12 | 1110 |

| Ölçü Size | Kod Code | a | b | z | z1 |
|--------------|-------------|----|----|----|----|
| SYH 1/2 | FS00400002 | 36 | 30 | 23 | |
| GLV 1/2 | FG00400002 | | | | |
| SYH 3/4 | FS00400003 | 43 | 36 | 28 | |
| GLV 3/4 | FG00400003 | | | | |
| SYH 1 | FS00400004 | 51 | 42 | 34 | |
| GLV 1 | FG00400004 | | | | |
| SYH 1 1/4 | FS00400005 | 64 | 54 | 45 | |
| GLV 1 1/4 | FG00400005 | | | | |
| SYH 1 1/2 | FS00400006 | 68 | 58 | 49 | |
| GLV 1 1/2 | FG00400006 | | | | |
| SYH 2 | FS00400007 | 81 | 70 | 57 | |
| GLV 2 | FG00400007 | | | | |

| | Ölçü Size | Kod Code | Poşet Bag | Kutu Carton | Gr Gr |
|-----|--------------|-------------|--------------|----------------|----------|
| SYH | 1/2 | FS00410002 | 10 | 160 | 137 |
| GLV | 1/2 | FG00410002 | 10 | 160 | 146 |
| SYH | 3/4 | FS00410003 | 10 | 80 | 219 |
| GLV | 3/4 | FG00410003 | 10 | 80 | 235 |
| SYH | 1 | FS00410004 | 10 | 50 | 333 |
| GLV | 1 | FG00410004 | 10 | 50 | 350 |
| SYH | 1 1/4 | FS00410005 | | 30 | 570 |
| GLV | 1 1/4 | FG00410005 | | 30 | 617 |
| SYH | 1 1/2 | FS00410006 | | 20 | 718 |
| GLV | 1 1/2 | FG00410006 | | 20 | 760 |
| SYH | 2 | FS00410007 | | 10 | 1.310 |
| GLV | 2 | FG00410007 | | 10 | 1.355 |

| | Ölçü Size | Kod Code | a | b | z | z1 |
|-----|--------------|-------------|----|---|----|----|
| SYH | 1/2 | FS00410002 | 36 | | 23 | |
| GLV | 1/2 | FG00410002 | | | | |
| SYH | 3/4 | FS00410003 | 43 | | 28 | |
| GLV | 3/4 | FG00410003 | | | | |
| SYH | 1 | FS00410004 | 51 | | 34 | |
| GLV | 1 | FG00410004 | | | | |
| SYH | 1 1/4 | FS00410005 | 64 | | 45 | |
| GLV | 1 1/4 | FG00410005 | | | | |
| SYH | 1 1/2 | FS00410006 | 68 | | 49 | |
| GLV | 1 1/2 | FG00410006 | | | | |
| SYH | 2 | FS00410007 | 81 | | 57 | |
| GLV | 2 | FG00410007 | | | | |



41
ISO/EN (G1/45°)
45° Deveboynu
(İç vidalı)
45° Long sweep
bend

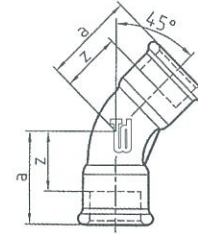

| | Ölçü Size | Kod Code | Poşet Bag | Kutu Carton | Gr Gr |
|-----|--------------|-------------|--------------|----------------|----------|
| SYH | 1/2 | FS00850002 | 10 | 100 | 186 |
| GLV | 1/2 | FG00850002 | 10 | 100 | 195 |
| SYH | 3/4 | FS00850003 | 10 | 70 | 297 |
| GLV | 3/4 | FG00850003 | 10 | 70 | 308 |
| SYH | 1 | FS00850004 | | 40 | 499 |
| GLV | 1 | FG00850004 | | 40 | 528 |

| | Ölçü Size | Kod Code | a | d | z | z1 |
|-----|--------------|-------------|----|---------|----|----|
| SYH | 1/2 | FS00850002 | 48 | 0.5in. | 36 | |
| GLV | 1/2 | FG00850002 | | | | |
| SYH | 3/4 | FS00850003 | 60 | 0.75in. | 45 | |
| GLV | 3/4 | FG00850003 | | | | |
| SYH | 1 | FS00850004 | 70 | 1in. | 53 | |
| GLV | 1 | FG00850004 | | | | |



85
Boru Atlama
Manşonu
Crossover

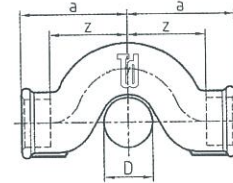

87

Boru Atlama
Te'si

Tee, with
crossover branch

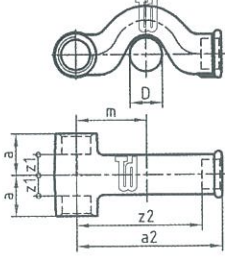

| | Ölçü Size | Kod Code | Poşet Bag | Kutu Carton | Gr Gr |
|-----|--------------|-------------|--------------|----------------|----------|
| SYH | 1/2 " | FS00870002 | 10 | 80 | 220 |
| GLV | 1/2 " | FG00870002 | 10 | 80 | 230 |

| | Ölçü Size | Kod Code | a | b | z | z1 | D |
|-----|--------------|-------------|----|----|----|----|---------|
| SYH | 1/2 " | FS00870002 | 26 | 93 | 13 | 80 | 0,5 in. |
| GLV | 1/2 " | FG00870002 | 26 | 93 | 13 | 80 | 0,5 in. |

90

ISO/EN (A1)

90° Dirsek

90° Elbow



| | Ölçü Size | Kod Code | Poşet Bag | Kutu Carton | Gr Gr |
|-----|--------------|-------------|--------------|----------------|----------|
| SYH | 3/8 " | FS00900001 | 10 | 350 | 72 |
| GLV | 3/8 " | FG00900001 | 10 | 350 | 74 |
| SYH | 1/2 " | FS00900002 | 10 | 270 | 97 |
| GLV | 1/2 " | FG00900002 | 10 | 270 | 102 |
| SYH | 3/4 " | FS00900003 | 10 | 150 | 162 |
| GLV | 3/4 " | FG00900003 | 10 | 150 | 168 |
| SYH | 1 " | FS00900004 | 10 | 100 | 239 |
| GLV | 1 " | FG00900004 | 10 | 100 | 264 |
| SYH | 1 1/4 " | FS00900005 | | 60 | 362 |
| GLV | 1 1/4 " | FG00900005 | | 60 | 380 |
| SYH | 1 1/2 " | FS00900006 | | 35 | 629 |
| GLV | 1 1/2 " | FG00900006 | | 35 | 650 |
| SYH | 2 " | FS00900007 | | 20 | 933 |
| GLV | 2 " | FG00900007 | | 20 | 994 |
| SYH | 2 1/2 " | FS00900008 | | 12 | 1.307 |
| GLV | 2 1/2 " | FG00900008 | | 12 | 1.376 |
| SYH | 3 " | FS00900009 | | 8 | 1.902 |
| GLV | 3 " | FG00900009 | | 8 | 2.021 |
| SYH | 4 " | FS00900000 | | 4 | 3.266 |
| GLV | 4 " | FG00900000 | | 4 | 3.326 |

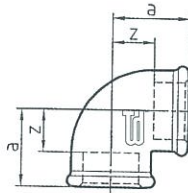

| | Ölçü Size | Kod Code | a | b | z | z1 |
|-----|--------------|-------------|----|---|----|----|
| SYH | 3/8 " | FS00900001 | 25 | | 15 | |
| GLV | 3/8 " | FG00900001 | | | | |
| SYH | 1/2 " | FS00900002 | 28 | | 15 | |
| GLV | 1/2 " | FG00900002 | | | | |
| SYH | 3/4 " | FS00900003 | 33 | | 18 | |
| GLV | 3/4 " | FG00900003 | | | | |
| SYH | 1 " | FS00900004 | 38 | | 21 | |
| GLV | 1 " | FG00900004 | | | | |
| SYH | 1 1/4 " | FS00900005 | 45 | | 26 | |
| GLV | 1 1/4 " | FG00900005 | | | | |
| SYH | 1 1/2 " | FS00900006 | 50 | | 31 | |
| GLV | 1 1/2 " | FG00900006 | | | | |
| SYH | 2 " | FS00900007 | 58 | | 34 | |
| GLV | 2 " | FG00900007 | | | | |
| SYH | 2 1/2 " | FS00900008 | 69 | | 42 | |
| GLV | 2 1/2 " | FG00900008 | | | | |
| SYH | 3 " | FS00900009 | 78 | | 48 | |
| GLV | 3 " | FG00900009 | | | | |
| SYH | 4 " | FS00900000 | 96 | | 60 | |
| GLV | 4 " | FG00900000 | | | | |

| | Ölçü Size | Kod Code | Poşet Bag | Kutu Carton | Gr Gr |
|-----|--------------|-------------|--------------|----------------|----------|
| SYH | 3/4 | FS90DT0003 | | 150 | 169 |
| SYH | 1 | FS90DT0004 | | 100 | 245 |
| SYH | 1 1/4 | FS90DT0005 | | 60 | 374 |
| SYH | 1 1/2 | FS90DT0006 | | 35 | 606 |
| SYH | 2 | FS90DT0007 | | 20 | 920 |

| | Ölçü Size | Kod Code | a | b | z |
|-----|--------------|-------------|----|------|----|
| SYH | 3/4 | FS90DT0003 | 33 | 27.5 | 18 |
| SYH | 1 | FS90DT0004 | 38 | 30 | 21 |
| SYH | 1 1/4 | FS90DT0005 | 45 | 36 | 26 |
| SYH | 1 1/2 | FS90DT0006 | 50 | 41.5 | 31 |
| SYH | 2 | FS90DT0007 | 58 | 47.5 | 34 |



90DT

Doğalgaz Test
Dirseği

Elbow

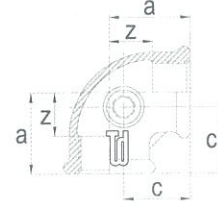

| | Ölçü Size | Kod Code | Poşet Bag | Kutu Carton | Gr Gr |
|-----|---------------|-------------|--------------|----------------|----------|
| SYH | 3/4-1/2 " | FS090R0032 | 10 | 150 | 136 |
| GLV | 3/4-1/2 " | FG090R0032 | 10 | 150 | 161 |
| SYH | 1-3/8 " | FS090R0041 | 10 | 120 | 195 |
| GLV | 1-3/8 " | FG090R0041 | 10 | 120 | 205 |
| SYH | 1-1/2 " | FS090R0042 | 10 | 120 | 190 |
| GLV | 1-1/2 " | FG090R0042 | 10 | 120 | 201 |
| SYH | 1-3/4 " | FS090R0043 | 10 | 100 | 219 |
| GLV | 1-3/4 " | FG090R0043 | 10 | 100 | 222 |
| SYH | 1 1/4-1/2 " | FS090R0052 | | 45 | 290 |
| GLV | 1 1/4-1/2 " | FG090R0052 | | 45 | 308 |
| SYH | 1 1/4-3/4 " | FS090R0053 | | 45 | 239 |
| GLV | 1 1/4-3/4 " | FG090R0053 | | 45 | 248 |
| SYH | 1 1/4-1 " | FS090R0054 | | 40 | 375 |
| GLV | 1 1/4-1 " | FG090R0054 | | 40 | 400 |
| SYH | 1 1/2-3/4 " | FS090R0063 | | 40 | 402 |
| GLV | 1 1/2-3/4 " | FG090R0063 | | 40 | 424 |
| SYH | 1 1/2-1 " | FS090R0064 | | 40 | 438 |
| GLV | 1 1/2-1 " | FG090R0064 | | 40 | 464 |
| SYH | 1 1/2-1 1/4 " | FS090R0065 | | 40 | 467 |
| GLV | 1 1/2-1 1/4 " | FG090R0065 | | 40 | 482 |
| SYH | 2-1 " | FS090R0074 | | 35 | 700 |
| GLV | 2-1 " | FG090R0074 | | 35 | 740 |
| SYH | 2-1 1/4 " | FS090R0075 | | 35 | 590 |
| GLV | 2-1 1/4 " | FG090R0075 | | 35 | 628 |
| SYH | 2-1 1/2 " | FS090R0076 | | 30 | 698 |
| GLV | 2-1 1/2 " | FG090R0076 | | 30 | 730 |

| | Ölçü Size | Kod Code | a | b | z1 | z2 |
|-----|---------------|-------------|----|----|----|----|
| SYH | 3/4-1/2 " | FS090R0032 | 30 | 31 | 15 | 18 |
| GLV | 3/4-1/2 " | FG090R0032 | | | | |
| SYH | 1-3/8 " | FS090R0041 | 32 | 34 | 12 | 21 |
| GLV | 1-3/8 " | FG090R0041 | | | | |
| SYH | 1-1/2 " | FS090R0042 | 32 | 34 | 15 | 21 |
| GLV | 1-1/2 " | FG090R0042 | | | | |
| SYH | 1-3/4 " | FS090R0043 | 35 | 36 | 18 | 21 |
| GLV | 1-3/4 " | FG090R0043 | | | | |
| SYH | 1 1/4-1/2 " | FS090R0052 | 34 | 38 | 15 | 25 |
| GLV | 1 1/4-1/2 " | FG090R0052 | | | | |
| SYH | 1 1/4-3/4 " | FS090R0053 | 36 | 41 | 17 | 26 |
| GLV | 1 1/4-3/4 " | FG090R0053 | | | | |
| SYH | 1 1/4-1 " | FS090R0054 | 40 | 42 | 21 | 25 |
| GLV | 1 1/4-1 " | FG090R0054 | | | | |
| SYH | 1 1/2-3/4 " | FS090R0063 | 38 | 44 | 19 | 29 |
| GLV | 1 1/2-3/4 " | FG090R0063 | | | | |
| SYH | 1 1/2-1 " | FS090R0064 | 42 | 46 | 23 | 29 |
| GLV | 1 1/2-1 " | FG090R0064 | | | | |
| SYH | 1 1/2-1 1/4 " | FS090R0065 | 46 | 48 | 27 | 29 |
| GLV | 1 1/2-1 1/4 " | FG090R0065 | | | | |
| SYH | 2-1 " | FS090R0074 | 46 | 53 | 22 | 36 |
| GLV | 2-1 " | FG090R0074 | | | | |
| SYH | 2-1 1/4 " | FS090R0075 | 48 | 53 | 24 | 33 |
| GLV | 2-1 1/4 " | FG090R0075 | | | | |
| SYH | 2-1 1/2 " | FS090R0076 | 52 | 55 | 28 | 36 |
| GLV | 2-1 1/2 " | FG090R0076 | | | | |



90R

ISO/EN(A1)

Redüksiyon
Dirsek

Elbow

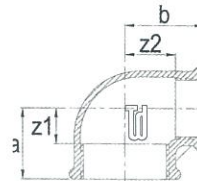

92

ISO/EN (A4)

90° Kuyruklu
Dirsek

Elbow



| | Ölçü Size | Kod Code | Poşet Bag | Kutu Carton | Gr Gr |
|-----|--------------|-------------|--------------|----------------|----------|
| SYH | 3/8 " | FS00920001 | 10 | 350 | 62 |
| GLV | 3/8 " | FG00920001 | 10 | 350 | 66 |
| SYH | 1/2 " | FS00920002 | 10 | 250 | 98 |
| GLV | 1/2 " | FG00920002 | 10 | 250 | 104 |
| SYH | 3/4 " | FS00920003 | 10 | 150 | 155 |
| GLV | 3/4 " | FG00920003 | 10 | 150 | 167 |
| SYH | 1 " | FS00920004 | 10 | 90 | 258 |
| GLV | 1 " | FG00920004 | 10 | 90 | 270 |
| SYH | 1 1/4 " | FS00920005 | | 50 | 410 |
| GLV | 1 1/4 " | FG00920005 | | 50 | 433 |
| SYH | 1 1/2 " | FS00920006 | | 40 | 585 |
| GLV | 1 1/2 " | FG00920006 | | 40 | 616 |
| SYH | 2 " | FS00920007 | | 20 | 878 |
| GLV | 2 " | FG00920007 | | 20 | 928 |
| SYH | 2 1/2 " | FS00920008 | | 12 | 1.514 |
| GLV | 2 1/2 " | FG00920008 | | 12 | 1.565 |
| SYH | 3 " | FS00920009 | | 8 | 2.082 |
| GLV | 3 " | FG00920009 | | 8 | 2.176 |
| SYH | 4 " | FS00920000 | | 4 | 3.030 |
| GLV | 4 " | FG00920000 | | 4 | 3.130 |

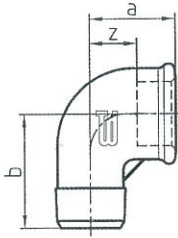

| | Ölçü Size | Kod Code | a | b | c | z |
|-----|--------------|-------------|----|-----|---|----|
| SYH | 3/8 " | FS00920001 | 25 | 32 | | 15 |
| GLV | 3/8 " | FG00920001 | | | | |
| SYH | 1/2 " | FS00920002 | 28 | 37 | | 15 |
| GLV | 1/2 " | FG00920002 | | | | |
| SYH | 3/4 " | FS00920003 | 33 | 43 | | 18 |
| GLV | 3/4 " | FG00920003 | | | | |
| SYH | 1 " | FS00920004 | 38 | 52 | | 21 |
| GLV | 1 " | FG00920004 | | | | |
| SYH | 1 1/4 " | FS00920005 | 45 | 60 | | 26 |
| GLV | 1 1/4 " | FG00920005 | | | | |
| SYH | 1 1/2 " | FS00920006 | 50 | 65 | | 31 |
| GLV | 1 1/2 " | FG00920006 | | | | |
| SYH | 2 " | FS00920007 | 58 | 74 | | 34 |
| GLV | 2 " | FG00920007 | | | | |
| SYH | 2 1/2 " | FS00920008 | 69 | 88 | | 42 |
| GLV | 2 1/2 " | FG00920008 | | | | |
| SYH | 3 " | FS00920009 | 78 | 98 | | 48 |
| GLV | 3 " | FG00920009 | | | | |
| SYH | 4 " | FS00920000 | 96 | 118 | | 60 |
| GLV | 4 " | FG00920000 | | | | |

92R

ISO/EN (A4)

Redüksiyon
Kuyruklu
Dirsek

Elbow

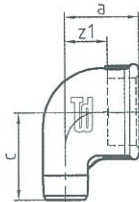

| | Ölçü Size | Kod Code | Poşet Bag | Kutu Carton | Gr Gr |
|-----|--------------|-------------|--------------|----------------|----------|
| SYH | 3/4-1/2 " | FS092R0032 | | 150 | 125 |
| GLV | 3/4-1/2 " | FG092R0032 | | 150 | 130 |

| | Ölçü Size | Kod Code | a | b | c | z | z1 |
|-----|--------------|-------------|----|---|----|---|----|
| SYH | 3/4-1/2 " | FS092R0032 | 30 | | 40 | | 18 |
| GLV | 3/4-1/2 " | FG092R0032 | | | | | |

| | Ölçü Size | Kod Code | Poşet Bag | Kutu Carton | Gr Gr |
|-----|--------------|-------------|--------------|----------------|----------|
| SYH | 1/2 " | FS00950002 | 10 | 90 | 258 |
| GLV | 1/2 " | FG00950002 | 10 | 90 | 305 |
| SYH | 3/4 " | FS00950003 | 10 | 50 | 378 |
| GLV | 3/4 " | FG00950003 | 10 | 50 | 432 |
| SYH | 1 " | FS00950004 | | 40 | 463 |
| GLV | 1 " | FG00950004 | | 40 | 540 |

| | Ölçü Size | Kod Code | a | c | z1 | z2 | s1 |
|-----|--------------|-------------|----|----|----|----|----|
| SYH | 1/2 " | FS00950002 | 58 | 28 | 15 | 45 | 26 |
| GLV | 1/2 " | FG00950002 | | | | | |
| SYH | 3/4 " | FS00950003 | 62 | 33 | 18 | 47 | 31 |
| GLV | 3/4 " | FG00950003 | | | | | |
| SYH | 1 " | FS00950004 | 72 | 38 | 21 | 55 | 38 |
| GLV | 1 " | FG00950004 | | | | | |



95

ISO/EN(UA1)

90° Köşe
Düz Rakor

Union elbows flat
seat

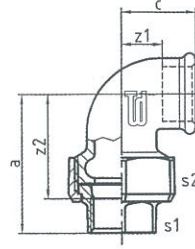

| | Ölçü Size | Kod Code | Poşet Bag | Kutu Carton | Gr Gr |
|-----|--------------|-------------|--------------|----------------|----------|
| SYH | 1/2 " | FS00960002 | 10 | 90 | 255 |
| GLV | 1/2 " | FG00960002 | 10 | 90 | 270 |
| SYH | 3/4 " | FS00960003 | 10 | 50 | 375 |
| GLV | 3/4 " | FG00960003 | 10 | 50 | 405 |
| SYH | 1 " | FS00960004 | | 40 | 453 |
| GLV | 1 " | FG00960004 | | 40 | 480 |

| | Ölçü Size | Kod Code | a | c | z1 | z2 | s1 |
|-----|--------------|-------------|----|----|----|----|----|
| SYH | 1/2 " | FS00960002 | 58 | 28 | 15 | 45 | 25 |
| GLV | 1/2 " | FG00960002 | | | | | |
| SYH | 3/4 " | FS00960003 | 62 | 33 | 18 | 47 | 32 |
| GLV | 3/4 " | FG00960003 | | | | | |
| SYH | 1 " | FS00960004 | 72 | 38 | 21 | 55 | 38 |
| GLV | 1 " | FG00960004 | | | | | |



96

ISO/EN(UA11)

90° Köşe
Konik Rakor

Union elbow taper
seat

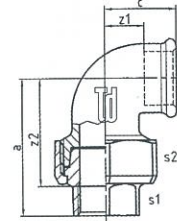

97

ISO/EN (UA2)

90° Kuyruklu
Düz Rakor

Union elbow flat
seat

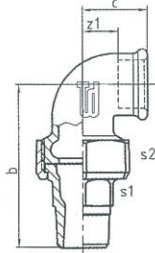

| | Ölçü Size | Kod Code | Poşet Bag | Kutu Carton | Gr Gr |
|-----|--------------|-------------|--------------|----------------|----------|
| SYH | 1/2 " | FS00970002 | 10 | 80 | 278 |
| GLV | 1/2 " | FG00970002 | 10 | 80 | 300 |
| SYH | 3/4 " | FS00970003 | 10 | 50 | 403 |
| GLV | 3/4 " | FG00970003 | 10 | 50 | 422 |
| SYH | 1 " | FS00970004 | | 40 | 529 |
| GLV | 1 " | FG00970004 | | 40 | 555 |

| | Ölçü Size | Kod Code | b | c | z1 | s1 | s2 |
|-----|--------------|-------------|----|----|----|----|----|
| SYH | 1/2 " | FS00970002 | 76 | 28 | 15 | 25 | 41 |
| GLV | 1/2 " | FG00970002 | | | | | |
| SYH | 3/4 " | FS00970003 | 82 | 33 | 18 | 31 | 50 |
| GLV | 3/4 " | FG00970003 | | | | | |
| SYH | 1 " | FS00970004 | 93 | 38 | 21 | 38 | 55 |
| GLV | 1 " | FG00970004 | | | | | |

98

ISO/EN (UA12)

90° Kuyruklu
Konik Rakor

Union elbow,
taper seat

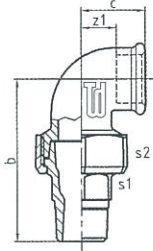

| | Ölçü Size | Kod Code | Poşet Bag | Kutu Carton | Gr Gr |
|-----|--------------|-------------|--------------|----------------|----------|
| SYH | 1/2 " | FS00980002 | 10 | 80 | 274 |
| GLV | 1/2 " | FG00980002 | 10 | 80 | 290 |
| SYH | 3/4 " | FS00980003 | 10 | 50 | 410 |
| GLV | 3/4 " | FG00980003 | 10 | 50 | 425 |
| SYH | 1 " | FS00980004 | | 40 | 527 |
| GLV | 1 " | FG00980004 | | 40 | 556 |

| | Ölçü Size | Kod Code | b | c | z1 | s1 | s2 |
|-----|--------------|-------------|----|----|----|----|----|
| SYH | 1/2 " | FS00980002 | 76 | 28 | 15 | 25 | 41 |
| GLV | 1/2 " | FG00980002 | | | | | |
| SYH | 3/4 " | FS00980003 | 82 | 33 | 18 | 31 | 50 |
| GLV | 3/4 " | FG00980003 | | | | | |
| SYH | 1 " | FS00980004 | 94 | 38 | 21 | 38 | 55 |
| GLV | 1 " | FG00980004 | | | | | |

120
ISO/EN (A1/45°)
45° Dirsek
45° Elbow

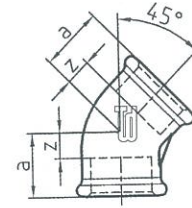

| | Ölçü Size | Kod Code | Poşet Bag | Kutu Carton | Gr Gr |
|-----|--------------|-------------|--------------|----------------|----------|
| SYH | 1/2 " | FS01200002 | 10 | 300 | 81 |
| GLV | 1/2 " | FG01200002 | 10 | 300 | 85 |
| SYH | 3/4 " | FS01200003 | 10 | 150 | 151 |
| GLV | 3/4 " | FG01200003 | 10 | 150 | 158 |
| SYH | 1 " | FS01200004 | | 100 | 236 |
| GLV | 1 " | FG01200004 | | 100 | 248 |
| SYH | 1 1/4 " | FS01200005 | | 50 | 374 |
| GLV | 1 1/4 " | FG01200005 | | 50 | 399 |
| SYH | 1 1/2 " | FS01200006 | | 40 | 460 |
| GLV | 1 1/2 " | FG01200006 | | 40 | 484 |
| SYH | 2 " | FS01200007 | | 20 | 837 |
| GLV | 2 " | FG01200007 | | 20 | 856 |
| SYH | 2 1/2 " | FS01200008 | | 12 | 1.227 |
| GLV | 2 1/2 " | FG01200008 | | 12 | 1.271 |

| | Ölçü Size | Kod Code | a | z |
|-----|--------------|-------------|----|----|
| SYH | 1/2 " | FS01200002 | 22 | 9 |
| GLV | 1/2 " | FG01200002 | | |
| SYH | 3/4 " | FS01200003 | 25 | 10 |
| GLV | 3/4 " | FG01200003 | | |
| SYH | 1 " | FS01200004 | 28 | 11 |
| GLV | 1 " | FG01200004 | | |
| SYH | 1 1/4 " | FS01200005 | 33 | 14 |
| GLV | 1 1/4 " | FG01200005 | | |
| SYH | 1 1/2 " | FS01200006 | 36 | 17 |
| GLV | 1 1/2 " | FG01200006 | | |
| SYH | 2 " | FS01200007 | 43 | 19 |
| GLV | 2 " | FG01200007 | | |
| SYH | 2 1/2 " | FS01200008 | 48 | 21 |
| GLV | 2 1/2 " | FG01200008 | | |

121
ISO/EN (A4/45°)
**45° Kuyruklu
Dirsek**
45° Elbow

| | Ölçü Size | Kod Code | Poşet Bag | Kutu Carton | Gr Gr |
|-----|--------------|-------------|--------------|----------------|----------|
| SYH | 1/2 " | FS01210002 | 10 | 300 | 79 |
| GLV | 1/2 " | FG01210002 | 10 | 300 | 85 |
| SYH | 3/4 " | FS01210003 | 10 | 150 | 134 |
| GLV | 3/4 " | FG01210003 | 10 | 150 | 139 |
| SYH | 1 " | FS01210004 | 10 | 100 | 200 |
| GLV | 1 " | FG01210004 | 10 | 100 | 207 |
| SYH | 1 1/4 " | FS01210005 | | 50 | 339 |
| GLV | 1 1/4 " | FG01210005 | | 50 | 357 |
| SYH | 1 1/2 " | FS01210006 | | 40 | 450 |
| GLV | 1 1/2 " | FG01210006 | | 40 | 477 |
| SYH | 2 " | FS01210007 | | 20 | 770 |
| GLV | 2 " | FG01210007 | | 20 | 772 |

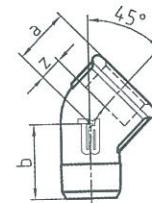
| | Ölçü Size | Kod Code | a | b | z |
|-----|--------------|-------------|----|----|----|
| SYH | 1/2 " | FS01210002 | 22 | 28 | 9 |
| GLV | 1/2 " | FG01210002 | | | |
| SYH | 3/4 " | FS01210003 | 25 | 32 | 10 |
| GLV | 3/4 " | FG01210003 | | | |
| SYH | 1 " | FS01210004 | 28 | 37 | 11 |
| GLV | 1 " | FG01210004 | | | |
| SYH | 1 1/4 " | FS01210005 | 33 | 43 | 14 |
| GLV | 1 1/4 " | FG01210005 | | | |
| SYH | 1 1/2 " | FS01210006 | 36 | 46 | 17 |
| GLV | 1 1/2 " | FG01210006 | | | |
| SYH | 2 " | FS01210007 | 43 | 55 | 19 |
| GLV | 2 " | FG01210007 | | | |



130

ISO/EN(B1)

Te

Tee

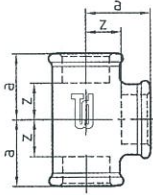

| | Ölçü Size | Kod Code | Poşet Bag | Kutu Carton | Gr Gr |
|-----|--------------|-------------|--------------|----------------|----------|
| SYH | 3/8 " | FS01300001 | 10 | 240 | 95 |
| GLV | 3/8 " | FG01300001 | 10 | 240 | 99 |
| SYH | 1/2 " | FS01300002 | 10 | 180 | 130 |
| GLV | 1/2 " | FG01300002 | 10 | 180 | 139 |
| SYH | 3/4 " | FS01300003 | 10 | 100 | 214 |
| GLV | 3/4 " | FG01300003 | 10 | 100 | 222 |
| SYH | 1 " | FS01300004 | 10 | 60 | 331 |
| GLV | 1 " | FG01300004 | 10 | 60 | 342 |
| SYH | 1 1/4 " | FS01300005 | | 35 | 517 |
| GLV | 1 1/4 " | FG01300005 | | 35 | 539 |
| SYH | 1 1/2 " | FS01300006 | | 25 | 671 |
| GLV | 1 1/2 " | FG01300006 | | 25 | 723 |
| SYH | 2 " | FS01300007 | | 15 | 1.097 |
| GLV | 2 " | FG01300007 | | 15 | 1.132 |
| SYH | 2 1/2 " | FS01300008 | | 8 | 1.592 |
| GLV | 2 1/2 " | FG01300008 | | 8 | 1.662 |
| SYH | 3 " | FS01300009 | | 6 | 2.252 |
| GLV | 3 " | FG01300009 | | 6 | 2.323 |
| SYH | 4 " | FS01300000 | | 3 | 4.100 |
| GLV | 4 " | FG01300000 | | 3 | 4.167 |

| | Ölçü Size | Kod Code | a | z |
|-----|--------------|-------------|----|----|
| SYH | 3/8 " | FS01300001 | 25 | 15 |
| GLV | 3/8 " | FG01300001 | | |
| SYH | 1/2 " | FS01300002 | 28 | 15 |
| GLV | 1/2 " | FG01300002 | | |
| SYH | 3/4 " | FS01300003 | 33 | 18 |
| GLV | 3/4 " | FG01300003 | | |
| SYH | 1 " | FS01300004 | 38 | 21 |
| GLV | 1 " | FG01300004 | | |
| SYH | 1 1/4 " | FS01300005 | 45 | 26 |
| GLV | 1 1/4 " | FG01300005 | | |
| SYH | 1 1/2 " | FS01300006 | 50 | 31 |
| GLV | 1 1/2 " | FG01300006 | | |
| SYH | 2 " | FS01300007 | 58 | 34 |
| GLV | 2 " | FG01300007 | | |
| SYH | 2 1/2 " | FS01300008 | 69 | 42 |
| GLV | 2 1/2 " | FG01300008 | | |
| SYH | 3 " | FS01300009 | 78 | 48 |
| GLV | 3 " | FG01300009 | | |
| SYH | 4 " | FS01300000 | 96 | 60 |
| GLV | 4 " | FG01300000 | | |

130R

ISO/EN(B1)

Inegal Tee

Tee



| | Ölçü Size | Kod Code | Poşet Bag | Kutu Carton | Gr Gr |
|-----|---------------------|-------------|--------------|----------------|----------|
| SYH | 1/2-3/4-1/2 " | FS130R0232 | 10 | 130 | 171 |
| GLV | 1/2-3/4-1/2 " | FG130R0232 | 10 | 130 | 165 |
| SYH | 3/4-1/2-1/2 " | FS130R0322 | 10 | 130 | 150 |
| GLV | 3/4-1/2-1/2 " | FG130R0322 | 10 | 130 | 165 |
| SYH | 3/4-1/2-3/4 " | FS130R0323 | 10 | 100 | 186 |
| GLV | 3/4-1/2-3/4 " | FG130R0323 | 10 | 100 | 194 |
| SYH | 3/4-3/4-1/2 " | FS130R0332 | 10 | 100 | 175 |
| GLV | 3/4-3/4-1/2 " | FG130R0332 | 10 | 100 | 184 |
| SYH | 3/4-1-1/2 " | FS130R0342 | 10 | 80 | 228 |
| GLV | 3/4-1-1/2 " | FG130R0342 | 10 | 80 | 238 |
| SYH | 3/4-1-3/4 " | FS130R0343 | 10 | 80 | 234 |
| GLV | 3/4-1-3/4 " | FG130R0343 | 10 | 80 | 246 |
| SYH | 1-1/2-1/2 " | FS130R0422 | 10 | 100 | 195 |
| GLV | 1-1/2-1/2 " | FG130R0422 | 10 | 100 | 208 |
| SYH | 1-1/2-3/4 " | FS130R0423 | 10 | 100 | 192 |
| GLV | 1-1/2-3/4 " | FG130R0423 | 10 | 100 | 211 |
| SYH | 1-3/8-1 " | FS130R0414 | 10 | 100 | 270 |
| GLV | 1-3/8-1 " | FG130R0414 | 10 | 100 | 280 |
| SYH | 1-1/2-1 " | FS130R0424 | 10 | 90 | 207 |
| GLV | 1-1/2-1 " | FG130R0424 | 10 | 90 | 219 |
| SYH | 1-3/4-1/2 " | FS130R0432 | 10 | 80 | 225 |
| GLV | 1-3/4-1/2 " | FG130R0432 | 10 | 80 | 240 |
| SYH | 1-3/4-3/4 " | FS130R0433 | 10 | 80 | 222 |
| GLV | 1-3/4-3/4 " | FG130R0433 | 10 | 80 | 237 |
| SYH | 1-3/4-1 " | FS130R0434 | 10 | 70 | 241 |
| GLV | 1-3/4-1 " | FG130R0434 | 10 | 70 | 256 |
| SYH | 1-1 1/4-3/4 " | FS130R0453 | | 50 | 388 |
| GLV | 1-1 1/4-3/4 " | FG130R0453 | | 50 | 320 |
| SYH | 1-1 1/4-1 " | FS130R0454 | | 50 | 409 |
| GLV | 1-1 1/4-1 " | FG130R0454 | | 50 | 429 |
| SYH | 1 1/4-3/8-1 1/4 " | FS130R0515 | | 30 | 385 |
| GLV | 1 1/4-3/8-1 1/4 " | FG130R0515 | | 30 | 400 |
| SYH | 1 1/4-1/2-1 " | FS130R0524 | | 55 | 294 |
| GLV | 1 1/4-1/2-1 " | FG130R0524 | | 55 | 312 |
| SYH | 1 1/4-1/2-1 1/4 " | FS130R0525 | | 55 | 371 |
| GLV | 1 1/4-1/2-1 1/4 " | FG130R0525 | | 55 | 405 |
| SYH | 1 1/4-3/4-1 " | FS130R0534 | | 48 | 325 |
| GLV | 1 1/4-3/4-1 " | FG130R0534 | | 48 | 342 |
| SYH | 1 1/4-3/4-1 1/4 " | FS130R0535 | | 55 | 382 |
| GLV | 1 1/4-3/4-1 1/4 " | FG130R0535 | | 55 | 400 |
| SYH | 1 1/4-1-3/4 " | FS130R0543 | | 48 | 380 |
| GLV | 1 1/4-1-3/4 " | FG130R0543 | | 48 | 405 |
| SYH | 1 1/4-1-1 " | FS130R0544 | | 36 | 410 |
| GLV | 1 1/4-1-1 " | FG130R0544 | | 36 | 425 |
| SYH | 1 1/4-1-1 1/4 " | FS130R0545 | | 50 | 440 |
| GLV | 1 1/4-1-1 1/4 " | FG130R0545 | | 50 | 475 |
| SYH | 1 1/4-1 1/4-1 " | FS130R0554 | | 50 | 495 |
| GLV | 1 1/4-1 1/4-1 " | FG130R0554 | | 50 | 520 |
| SYH | 1 1/4-1 1/2-1 1/4 " | FS130R0565 | | 30 | 645 |
| GLV | 1 1/4-1 1/2-1 1/4 " | FG130R0565 | | 30 | 670 |
| SYH | 1 1/2-1/2-1 1/2 " | FS130R0626 | | 45 | 385 |
| GLV | 1 1/2-1/2-1 1/2 " | FG130R0626 | | 45 | 395 |
| SYH | 1 1/2-3/4-1 1/2 " | FS130R0636 | | 45 | 413 |
| GLV | 1 1/2-3/4-1 1/2 " | FG130R0636 | | 45 | 438 |
| SYH | 1 1/2-1-1 1/4 " | FS130R0645 | | 32 | 518 |
| GLV | 1 1/2-1-1 1/4 " | FG130R0645 | | 32 | 534 |
| SYH | 1 1/2-1-1 1/2 " | FS130R0646 | | 30 | 524 |
| GLV | 1 1/2-1-1 1/2 " | FG130R0646 | | 30 | 555 |
| SYH | 1 1/2-1 1/4-1 1/4 " | FS130R0655 | | 30 | 625 |
| GLV | 1 1/2-1 1/4-1 1/4 " | FG130R0655 | | 30 | 650 |
| SYH | 1 1/2-1 1/4-1 1/2 " | FS130R0656 | | 30 | 555 |
| GLV | 1 1/2-1 1/4-1 1/2 " | FG130R0656 | | 30 | 580 |
| SYH | 1 1/2-3/4-1 1/4 " | FS130R0635 | | 32 | 434 |
| GLV | 1 1/2-3/4-1 1/4 " | FG130R0635 | | 32 | 440 |
| SYH | 2-1/2-2 " | FS130R0727 | | 20 | 784 |
| GLV | 2-1/2-2 " | FG130R0727 | | 20 | 815 |
| SYH | 2-3/4-2 " | FS130R0737 | | 20 | 790 |
| GLV | 2-3/4-2 " | FG130R0737 | | 20 | 819 |

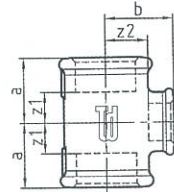
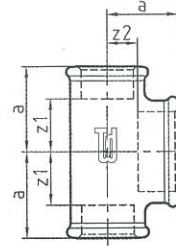
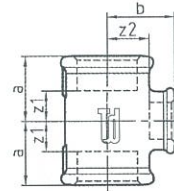

130R

ISO/EN(B1)

Inegal Tee

Tee

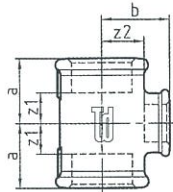
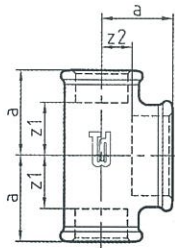
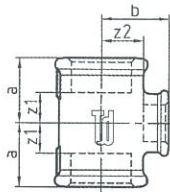

| | | | | |
|-----|-----------------|------------|----|-------|
| SYH | 2-1-1 1/2 " | FS130R0746 | 20 | 699 |
| GLV | 2-1-1 1/2 " | FG130R0746 | 20 | 725 |
| SYH | 2-1-2 " | FS130R0747 | 20 | 893 |
| GLV | 2-1-2 " | FG130R0747 | 20 | 918 |
| SYH | 2-1 1/4-1 1/2 " | FS130R0756 | 20 | 880 |
| GLV | 2-1 1/4-1 1/2 " | FG130R0756 | 20 | 915 |
| SYH | 2-1 1/4-2 " | FS130R0757 | 20 | 817 |
| GLV | 2-1 1/4-2 " | FG130R0757 | 20 | 862 |
| SYH | 2-1 1/2-2 " | FS130R0767 | 20 | 712 |
| GLV | 2-1 1/2-2 " | FG130R0767 | 20 | 868 |
| SYH | 2-2-1 " | FS130R0774 | 20 | 1.158 |
| GLV | 2-2-1 " | FG130R0774 | 20 | 1.070 |
| SYH | 2 1/2-2-2 1/2 " | FS130R0878 | 12 | 1.370 |
| GLV | 2 1/2-2-2 1/2 " | FG130R0878 | 12 | 1.401 |
| SYH | 3-2-3 " | FS130R0979 | 8 | 2.222 |
| GLV | 3-2-3 " | FG130R0979 | 8 | 2.265 |

130R

ISO/EN(B1)
Inegal Tee
Tee



| | Ölçü Size | Kod Code | a | b | c | z1 | z2 |
|-----|--------------------|-------------|----|----|----|----|----|
| SYH | 1/2-3/4-1/2" | FS130R0232 | 31 | 30 | | 18 | 15 |
| GLV | 1/2-3/4-1/2" | FG130R0232 | | | | | |
| SYH | 3/4-1/2-1/2" | FS130R0322 | 30 | 31 | 28 | 15 | 18 |
| GLV | 3/4-1/2-1/2" | FG130R0322 | | | | | |
| SYH | 3/4-1/2-3/4" | FS130R0323 | 30 | 31 | | 15 | 18 |
| GLV | 3/4-1/2-3/4" | FG130R0323 | | | | | |
| SYH | 3/4-3/4-1/2" | FS130R0332 | 33 | 33 | 31 | 18 | 18 |
| GLV | 3/4-3/4-1/2" | FG130R0332 | | | | | |
| SYH | 3/4-1-1/2" | FS130R0342 | 36 | 35 | 34 | 21 | 18 |
| GLV | 3/4-1-1/2" | FG130R0342 | | | | | |
| SYH | 3/4-1-3/4" | FS130R0343 | 36 | 35 | | 21 | 18 |
| GLV | 3/4-1-3/4" | FG130R0343 | | | | | |
| SYH | 1-1/2-1/2" | FS130R0422 | 32 | 34 | 28 | 15 | 21 |
| GLV | 1-1/2-1/2" | FG130R0422 | | | | | |
| SYH | 1-1/2-3/4" | FS130R0423 | 32 | 34 | 30 | 15 | 21 |
| GLV | 1-1/2-3/4" | FG130R0423 | | | | | |
| SYH | 1-3/8-1" | FS130R0414 | 30 | 32 | | 13 | 22 |
| GLV | 1-3/8-1" | FG130R0414 | | | | | |
| SYH | 1-1/2-1" | FS130R0424 | 32 | 34 | | 15 | 21 |
| GLV | 1-1/2-1" | FG130R0424 | | | | | |
| SYH | 1-3/4-1/2" | FS130R0432 | 35 | 36 | 31 | 18 | 21 |
| GLV | 1-3/4-1/2" | FG130R0432 | | | | | |
| SYH | 1-3/4-3/4" | FS130R0433 | 35 | 36 | 33 | 18 | 21 |
| GLV | 1-3/4-3/4" | FG130R0433 | | | | | |
| SYH | 1-3/4-1" | FS130R0434 | 35 | 36 | | 18 | 21 |
| GLV | 1-3/4-1" | FG130R0434 | | | | | |
| SYH | 1-1 1/4-3/4" | FS130R0453 | 42 | 40 | 41 | 25 | 21 |
| GLV | 1-1 1/4-3/4" | FG130R0453 | | | | | |
| SYH | 1-1 1/4-1" | FS130R0454 | 42 | 40 | | 25 | 21 |
| GLV | 1-1 1/4-1" | FG130R0454 | | | | | |
| SYH | 1 1/4-3/8-1 1/4" | FS130R0515 | 32 | 36 | | 15 | 27 |
| GLV | 1 1/4-3/8-1 1/4" | FG130R0515 | | | | | |
| SYH | 1 1/4-1/2-1" | FS130R0524 | 34 | 38 | 32 | 15 | 25 |
| GLV | 1 1/4-1/2-1" | FG130R0524 | | | | | |
| SYH | 1 1/4-1/2-1 1/4" | FS130R0525 | 34 | 38 | | 15 | 25 |
| GLV | 1 1/4-1/2-1 1/4" | FG130R0525 | | | | | |
| SYH | 1 1/4-3/4-1" | FS130R0534 | 36 | 41 | 35 | 17 | 26 |
| GLV | 1 1/4-3/4-1" | FG130R0534 | | | | | |
| SYH | 1 1/4-3/4-1 1/4" | FS130R0535 | 36 | 41 | | 17 | 26 |
| GLV | 1 1/4-3/4-1 1/4" | FG130R0535 | | | | | |
| SYH | 1 1/4-1-3/4" | FS130R0543 | 40 | 42 | 36 | 21 | 25 |
| GLV | 1 1/4-1-3/4" | FG130R0543 | | | | | |
| SYH | 1 1/4-1-1" | FS130R0544 | 40 | 42 | 38 | 21 | 25 |
| GLV | 1 1/4-1-1" | FG130R0544 | | | | | |
| SYH | 1 1/4-1-1 1/4" | FS130R0545 | 40 | 42 | | 21 | 25 |
| GLV | 1 1/4-1-1 1/4" | FG130R0545 | | | | | |
| SYH | 1 1/4-1 1/4-1" | FS130R0554 | 45 | 45 | 42 | 26 | 26 |
| GLV | 1 1/4-1 1/4-1" | FG130R0554 | | | | | |
| SYH | 1 1/4-1 1/2-1 1/4" | FS130R0565 | 48 | 46 | | 29 | 27 |
| GLV | 1 1/4-1 1/2-1 1/4" | FG130R0565 | | | | | |
| SYH | 1 1/2-1/2-1 1/2" | FS130R0626 | 36 | 42 | | 17 | 29 |
| GLV | 1 1/2-1/2-1 1/2" | FG130R0626 | | | | | |
| SYH | 1 1/2-3/4-1 1/2" | FS130R0636 | 38 | 44 | | 19 | 29 |
| GLV | 1 1/2-3/4-1 1/2" | FG130R0636 | | | | | |
| SYH | 1 1/2-1-1 1/4" | FS130R0645 | 42 | 46 | 40 | 23 | 29 |
| GLV | 1 1/2-1-1 1/4" | FG130R0645 | | | | | |
| SYH | 1 1/2-1-1 1/2" | FS130R0646 | 42 | 46 | | 23 | 29 |
| GLV | 1 1/2-1-1 1/2" | FG130R0646 | | | | | |
| SYH | 1 1/2-1 1/4-1 1/4" | FS130R0655 | 46 | 48 | 45 | 27 | 29 |
| GLV | 1 1/2-1 1/4-1 1/4" | FG130R0655 | | | | | |
| SYH | 1 1/2-1 1/4-1 1/2" | FS130R0656 | 46 | 48 | | 27 | 29 |
| GLV | 1 1/2-1 1/4-1 1/2" | FG130R0656 | | | | | |
| SYH | 1 1/2-3/4-1 1/4" | FS130R0635 | 38 | 44 | 36 | 17 | 29 |
| GLV | 1 1/2-3/4-1 1/4" | FG130R0635 | | | | | |
| SYH | 2-1/2-2" | FS130R0727 | 38 | 48 | | 14 | 35 |
| GLV | 2-1/2-2" | FG130R0727 | | | | | |
| SYH | 2-3/4-2" | FS130R0737 | 40 | 50 | | 16 | 35 |
| GLV | 2-3/4-2" | FG130R0737 | | | | | |

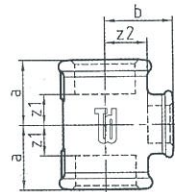
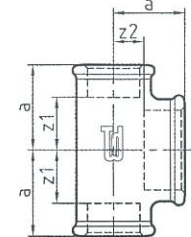
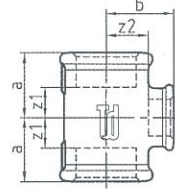

130R
ISO/EN (B1)

Inegal Tee

Tee

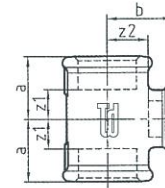
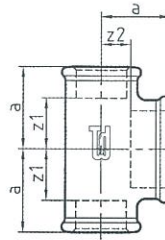
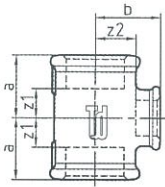

| | | | | | | | |
|-----|-----------------|------------|----|----|----|----|----|
| SYH | 2-1-1 1/2 " | FS130R0746 | 44 | 52 | 42 | 20 | 35 |
| GLV | 2-1-1 1/2 " | FG130R0746 | | | | | |
| SYH | 2-1-2 " | FS130R0747 | 44 | 52 | | 20 | 35 |
| GLV | 2-1-2 " | FG130R0747 | | | | | |
| SYH | 2-1 1/4-1 1/2 " | FS130R0756 | 48 | 54 | 46 | 24 | 35 |
| GLV | 2-1 1/4-1 1/2 " | FG130R0756 | | | | | |
| SYH | 2-1 1/4-2 " | FS130R0757 | 48 | 54 | | 24 | 35 |
| GLV | 2-1 1/4-2 " | FG130R0757 | | | | | |
| SYH | 2-1 1/2-2 " | FS130R0767 | 52 | 55 | | 28 | 36 |
| GLV | 2-1 1/2-2 " | FG130R0767 | | | | | |
| SYH | 2-2-1 " | FS130R0774 | 58 | 58 | 52 | 34 | 34 |
| GLV | 2-2-1 " | FG130R0774 | | | | | |
| SYH | 2 1/2-2-2 1/2 " | FS130R0878 | 61 | 66 | | 34 | 42 |
| GLV | 2 1/2-2-2 1/2 " | FG130R0878 | | | | | |
| SYH | 3-2-3 " | FG130R0979 | 64 | 73 | | 34 | 49 |
| GLV | 3-2-3 " | FG130R0979 | | | | | |

| | Ölçü Size | Kod Code | Poşet Bag | Kutu Carton | Gr Gr |
|-----|--------------|-------------|--------------|----------------|----------|
| SYH | 1/2 " | FS01310002 | 10 | 150 | 166 |
| GLV | 1/2 " | FG01310002 | 10 | 150 | 176 |
| SYH | 3/4 " | FS01310003 | 10 | 70 | 255 |
| GLV | 3/4 " | FG01310003 | 10 | 70 | 265 |
| SYH | 1 " | FS01310004 | 10 | 50 | 525 |
| GLV | 1 " | FG01310004 | 10 | 50 | 540 |
| SYH | 2 " | FS01310007 | 10 | 10 | 1.840 |
| GLV | 2 " | FG01310007 | 10 | 10 | 1.900 |



131
ISO/EN(E1)

Kavisli Te
Tee

| | Ölçü Size | Kod Code | a | c | z | z3 |
|-----|--------------|-------------|-----|----|----|----|
| SYH | 1/2 " | FS01310002 | 45 | 24 | 32 | 11 |
| GLV | 1/2 " | FG01310002 | | | | |
| SYH | 3/4 " | FS01310003 | 50 | 28 | 35 | 13 |
| GLV | 3/4 " | FG01310003 | | | | |
| SYH | 1 " | FS01310004 | 63 | 33 | 46 | 16 |
| GLV | 1 " | FG01310004 | | | | |
| SYH | 2 " | FS01310007 | 102 | 53 | 78 | 29 |
| GLV | 2 " | FG01310007 | | | | |

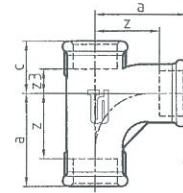

| | Ölçü Size | Kod Code | Poşet Bag | Kutu Carton | Gr Gr |
|-----|--------------|-------------|--------------|----------------|----------|
| SYH | 1/2 " | FS01800002 | 10 | 120 | 154 |
| GLV | 1/2 " | FG01800002 | 10 | 120 | 171 |
| SYH | 3/4 " | FS01800003 | 10 | 70 | 266 |
| GLV | 3/4 " | FG01800003 | 10 | 70 | 280 |
| SYH | 1 " | FS01800004 | | 40 | 409 |
| GLV | 1 " | FG01800004 | | 40 | 440 |
| SYH | 1 1/4 " | FS01800005 | | 30 | 618 |
| GLV | 1 1/4 " | FG01800005 | | 30 | 652 |
| SYH | 1 1/2 " | FS01800006 | | 25 | 730 |
| GLV | 1 1/2 " | FG01800006 | | 25 | 772 |
| SYH | 2 " | FS01800007 | | 15 | 1.390 |
| GLV | 2 " | FG01800007 | | 15 | 1.430 |
| SYH | 2 1/2 " | FS01800008 | | 6 | 1.710 |
| GLV | 2 1/2 " | FG01800008 | | 6 | 1.750 |
| SYH | 3 " | FS01800009 | | 4 | 2.850 |
| GLV | 3 " | FG01800009 | | 4 | 2.960 |



180
ISO/EN(C1)

Kuruva
Cross

| | Ölçü Size | Kod Code | a | b | z | z1 |
|-----|--------------|-------------|----|---|----|----|
| SYH | 1/2 " | FS01800002 | 28 | | 15 | |
| GLV | 1/2 " | FG01800002 | | | | |
| SYH | 3/4 " | FS01800003 | 33 | | 18 | |
| GLV | 3/4 " | FG01800003 | | | | |
| SYH | 1 " | FS01800004 | 38 | | 21 | |
| GLV | 1 " | FG01800004 | | | | |
| SYH | 1 1/4 " | FS01800005 | 45 | | 26 | |
| GLV | 1 1/4 " | FG01800005 | | | | |
| SYH | 1 1/2 " | FS01800006 | 50 | | 31 | |
| GLV | 1 1/2 " | FG01800006 | | | | |
| SYH | 2 " | FS01800007 | 58 | | 34 | |
| GLV | 2 " | FG01800007 | | | | |
| SYH | 2 1/2 " | FS01800008 | 69 | | 42 | |
| GLV | 2 1/2 " | FG01800008 | | | | |
| SYH | 3 " | FS01800009 | | | | |
| GLV | 3 " | FG01800009 | | | | |

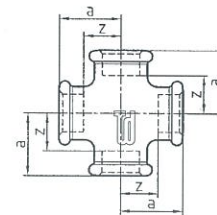

180R

ISO/EN(C1)

Inegal Kuruva
Cross



| | Ölçü Size | Kod Code | Poşet Bag | Kutu Carton | Gr Gr |
|-----|-------------------|-------------|--------------|----------------|----------|
| SYH | 3/4-1/2-3/4-1/2 " | FS180R3232 | | 80 | 200 |
| GLV | 3/4-1/2-3/4-1/2 " | FG180R3232 | | 80 | 215 |
| SYH | 1-1/2-1-1/2 " | FS180R4242 | | 60 | 270 |
| GLV | 1-1/2-1-1/2 " | FG180R4242 | | 60 | 283 |
| SYH | 1-3/4-1-3/4 " | FS180R4343 | | 60 | 324 |
| GLV | 1-3/4-1-3/4 " | FG180R4343 | | 60 | 340 |
| SYH | 1 1/4-1-1 1/4-1 " | FS180R5454 | | 30 | 482 |
| GLV | 1 1/4-1-1 1/4-1 " | FG180R5454 | | 30 | 515 |
| SYH | 1 1/2-1-1 1/2-1 " | FS180R6464 | | 25 | 555 |
| GLV | 1 1/2-1-1 1/2-1 " | FG180R6464 | | 25 | 598 |

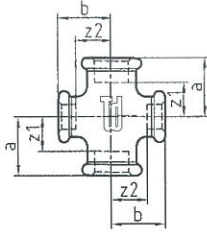

| | Ölçü Size | Kod Code | a | b | z | z1 | z2 |
|-----|-------------------|-------------|----|----|----|----|----|
| SYH | 3/4-1/2-3/4-1/2 " | FS180R3232 | 30 | 31 | 15 | 18 | |
| GLV | 3/4-1/2-3/4-1/2 " | FG180R3232 | | | | | |
| SYH | 1-1/2-1-1/2 " | FS180R4242 | 32 | 34 | 15 | 21 | |
| GLV | 1-1/2-1-1/2 " | FG180R4242 | | | | | |
| SYH | 1-3/4-1-3/4 " | FS180R4343 | 35 | 36 | 18 | 21 | |
| GLV | 1-3/4-1-3/4 " | FG180R4343 | | | | | |
| SYH | 1 1/4-1-1 1/4-1 " | FS180R5454 | 40 | 42 | 21 | 25 | |
| GLV | 1 1/4-1-1 1/4-1 " | FG180R5454 | | | | | |
| SYH | 1 1/2-1-1 1/2-1 " | FS180R6464 | 42 | 46 | 23 | 29 | |
| GLV | 1 1/2-1-1 1/2-1 " | FG180R6464 | | | | | |

| | Ölçü Size | Kod Code | Poşet Bag | Kutu Carton | Gr Gr |
|-----|---------------|-------------|--------------|----------------|----------|
| SYH | 3/4-3/8 " | FS02400031 | | 250 | 90 |
| GLV | 3/4-3/8 " | FG02400031 | | 250 | 116 |
| SYH | 3/4-1/2 " | FS02400032 | 10 | 250 | 98 |
| GLV | 3/4-1/2 " | FG02400032 | 10 | 250 | 102 |
| SYH | 1-1/2 " | FS02400042 | 10 | 150 | 168 |
| GLV | 1-1/2 " | FG02400042 | 10 | 150 | 176 |
| SYH | 1-3/4 " | FS02400043 | 10 | 140 | 173 |
| GLV | 1-3/4 " | FG02400043 | 10 | 140 | 180 |
| SYH | 1 1/4-3/4 " | FS02400053 | | 100 | 238 |
| GLV | 1 1/4-3/4 " | FG02400053 | | 100 | 251 |
| SYH | 1 1/4-1 " | FS02400054 | 10 | 100 | 223 |
| GLV | 1 1/4-1 " | FG02400054 | 10 | 100 | 234 |
| SYH | 1 1/2-1/2 " | FS02400062 | | 70 | 354 |
| GLV | 1 1/2-1/2 " | FG02400062 | | 70 | 367 |
| SYH | 1 1/2-3/4 " | FS02400063 | | 70 | 326 |
| GLV | 1 1/2-3/4 " | FG02400063 | | 70 | 340 |
| SYH | 1 1/2-1 " | FS02400064 | | 70 | 317 |
| GLV | 1 1/2-1 " | FG02400064 | | 70 | 325 |
| SYH | 1 1/2-1 1/4 " | FS02400065 | | 70 | 282 |
| GLV | 1 1/2-1 1/4 " | FG02400065 | | 70 | 303 |
| SYH | 2-1/2 " | FS02400072 | | 50 | 540 |
| GLV | 2-1/2 " | FG02400072 | | 50 | 565 |
| SYH | 2-3/4 " | FS02400073 | | 45 | 532 |
| GLV | 2-3/4 " | FG02400073 | | 45 | 547 |
| SYH | 2-1 " | FS02400074 | | 40 | 511 |
| GLV | 2-1 " | FG02400074 | | 40 | 521 |
| SYH | 2-1 1/4 " | FS02400075 | | 40 | 464 |
| GLV | 2-1 1/4 " | FG02400075 | | 40 | 480 |
| SYH | 2-1 1/2 " | FS02400076 | | 40 | 440 |
| GLV | 2-1 1/2 " | FG02400076 | | 40 | 462 |
| SYH | 3-2 " | FS02400097 | | 20 | 1.212 |
| GLV | 3-2 " | FG02400097 | | 20 | 1.231 |
| SYH | 4-2 " | FS02400007 | | 10 | 1.405 |
| GLV | 4-2 " | FG02400007 | | 10 | 2.103 |
| SYH | 4-3 " | FS02400009 | | 10 | 2.058 |
| GLV | 4-3 " | FG02400009 | | 10 | 1.625 |



240
ISO/EN (M2)

Manşon
Redüksiyon

Socket

| | Ölçü Size | Kod Code | a | z2 |
|-----|---------------|-------------|----|----|
| SYH | 3/4-3/8 " | FS02400031 | 39 | 14 |
| GLV | 3/4-3/8 " | FG02400031 | | |
| SYH | 3/4-1/2 " | FS02400032 | 39 | 11 |
| GLV | 3/4-1/2 " | FG02400032 | | |
| SYH | 1-1/2 " | FS02400042 | 45 | 15 |
| GLV | 1-1/2 " | FG02400042 | | |
| SYH | 1-3/4 " | FS02400043 | 45 | 13 |
| GLV | 1-3/4 " | FG02400043 | | |
| SYH | 1 1/4-3/4 " | FS02400053 | 50 | 16 |
| GLV | 1 1/4-3/4 " | FG02400053 | | |
| SYH | 1 1/4-1 " | FS02400054 | 50 | 14 |
| GLV | 1 1/4-1 " | FG02400054 | | |
| SYH | 1 1/2-1/2 " | FS02400062 | 55 | 23 |
| GLV | 1 1/2-1/2 " | FG02400062 | | |
| SYH | 1 1/2-3/4 " | FS02400063 | 55 | 21 |
| GLV | 1 1/2-3/4 " | FG02400063 | | |
| SYH | 1 1/2-1 " | FS02400064 | 55 | 19 |
| GLV | 1 1/2-1 " | FG02400064 | | |
| SYH | 1 1/2-1 1/4 " | FS02400065 | 55 | 17 |
| GLV | 1 1/2-1 1/4 " | FG02400065 | | |
| SYH | 2-1/2 " | FS02400072 | 65 | 28 |
| GLV | 2-1/2 " | FG02400072 | | |
| SYH | 2-3/4 " | FS02400073 | 65 | 26 |
| GLV | 2-3/4 " | FG02400073 | | |
| SYH | 2-1 " | FS02400074 | 65 | 24 |
| GLV | 2-1 " | FG02400074 | | |
| SYH | 2-1 1/4 " | FS02400075 | 65 | 22 |
| GLV | 2-1 1/4 " | FG02400075 | | |
| SYH | 2-1 1/2 " | FS02400076 | 65 | 22 |
| GLV | 2-1 1/2 " | FG02400076 | | |
| SYH | 3-2 " | FS02400097 | 80 | 26 |
| GLV | 3-2 " | FG02400097 | | |
| SYH | 4-2 " | FS02400007 | 94 | 34 |
| GLV | 4-2 " | FG02400007 | | |
| SYH | 4-3 " | FS02400009 | 94 | 28 |
| GLV | 4-3 " | FG02400009 | | |

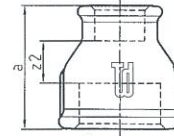

241

ISO/EN (N4)

Redüksiyon

Redcing bush

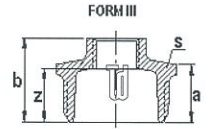
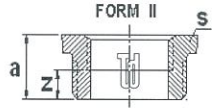
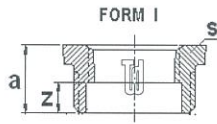

| | Ölçü Size | Kod Code | Poşet Bag | Kutu Carton | Gr Gr |
|-----|---------------|-------------|--------------|----------------|----------|
| SYH | 1/2-3/8 " | FS02410021 | 10 | 600 | 36 |
| GLV | 1/2-3/8 " | FG02410021 | 10 | 600 | 38 |
| SYH | 3/4-3/8 " | FS02410031 | 10 | 450 | 79 |
| GLV | 3/4-3/8 " | FG02410031 | 10 | 450 | 65 |
| SYH | 3/4-1/2 " | FS02410032 | 10 | 450 | 50 |
| GLV | 3/4-1/2 " | FG02410032 | 10 | 450 | 53 |
| SYH | 1-3/8 " | FS02410041 | 10 | 250 | 125 |
| GLV | 1-3/8 " | FG02410041 | 10 | 250 | 130 |
| SYH | 1-1/2 " | FS02410042 | 10 | 250 | 115 |
| GLV | 1-1/2 " | FG02410042 | 10 | 250 | 119 |
| SYH | 1-3/4 " | FS02410043 | 10 | 250 | 96 |
| GLV | 1-3/4 " | FG02410043 | 10 | 250 | 101 |
| SYH | 1 1/4-1/2 " | FS02410052 | 10 | 140 | 187 |
| GLV | 1 1/4-1/2 " | FG02410052 | 10 | 140 | 190 |
| SYH | 1 1/4-3/4 " | FS02410053 | 10 | 150 | 161 |
| GLV | 1 1/4-3/4 " | FG02410053 | 10 | 150 | 167 |
| SYH | 1 1/4-1 " | FS02410054 | 10 | 150 | 125 |
| GLV | 1 1/4-1 " | FG02410054 | 10 | 150 | 128 |
| SYH | 1 1/2-1/2 " | FS02410062 | 10 | 120 | 240 |
| GLV | 1 1/2-1/2 " | FG02410062 | 10 | 120 | 269 |
| SYH | 1 1/2-3/4 " | FS02410063 | 10 | 120 | 229 |
| GLV | 1 1/2-3/4 " | FG02410063 | 10 | 120 | 233 |
| SYH | 1 1/2-1 " | FS02410064 | 10 | 140 | 205 |
| GLV | 1 1/2-1 " | FG02410064 | 10 | 140 | 207 |
| SYH | 1 1/2-1 1/4 " | FS02410065 | 10 | 150 | 128 |
| GLV | 1 1/2-1 1/4 " | FG02410065 | 10 | 150 | 132 |
| SYH | 2-1/2 " | FS02410072 | | 65 | 362 |
| GLV | 2-1/2 " | FG02410072 | | 65 | 374 |
| SYH | 2-3/4 " | FS02410073 | | 65 | 375 |
| GLV | 2-3/4 " | FG02410073 | | 65 | 386 |
| SYH | 2-1 " | FS02410074 | | 60 | 389 |
| GLV | 2-1 " | FG02410074 | | 60 | 398 |
| SYH | 2-1 1/4 " | FS02410075 | | 60 | 333 |
| GLV | 2-1 1/4 " | FG02410075 | | 60 | 350 |
| SYH | 2-1 1/2 " | FS02410076 | | 75 | 293 |
| GLV | 2-1 1/2 " | FG02410076 | | 75 | 297 |
| SYH | 2 1/2-1 " | FS02410084 | | 30 | 677 |
| GLV | 2 1/2-1 " | FG02410084 | | 30 | 682 |
| SYH | 2 1/2-1 1/4 " | FS02410085 | | 30 | 702 |
| GLV | 2 1/2-1 1/4 " | FG02410085 | | 30 | 723 |
| SYH | 2 1/2-1 1/2 " | FS02410086 | | 35 | 629 |
| GLV | 2 1/2-1 1/2 " | FG02410086 | | 35 | 637 |
| SYH | 2 1/2-2 " | FS02410087 | | 35 | 500 |
| GLV | 2 1/2-2 " | FG02410087 | | 35 | 513 |
| SYH | 3-1 " | FS02410094 | | 30 | 968 |
| GLV | 3-1 " | FG02410094 | | 30 | 986 |
| SYH | 3-1 1/4 " | FS02410095 | | 30 | 900 |
| GLV | 3-1 1/4 " | FG02410095 | | 30 | 954 |
| SYH | 3-1 1/2 " | FS02410096 | | 30 | 945 |
| GLV | 3-1 1/2 " | FG02410096 | | 30 | 975 |
| SYH | 3-2 " | FS02410097 | | 30 | 980 |
| GLV | 3-2 " | FG02410097 | | 30 | 1.010 |
| SYH | 3-2 1/2 " | FS02410098 | | 30 | 665 |
| GLV | 3-2 1/2 " | FG02410098 | | 30 | 692 |
| SYH | 4-2 " | FS02410007 | | 16 | 1.640 |
| GLV | 4-2 " | FG02410007 | | 16 | 1.683 |
| SYH | 4-2 1/2 " | FS02410008 | | 16 | 1.659 |
| GLV | 4-2 1/2 " | FG02410008 | | 16 | 1.720 |
| SYH | 4-3 " | FS02410009 | | 16 | 1.533 |
| GLV | 4-3 " | FG02410009 | | 16 | 1.551 |

241
ISO/EN (N4)
Redüksiyon
Reducing bush

| | Ölçü Size | Kod Code | a | b | s | z |
|-----|---------------|-------------|----|----|-----|----|
| SYH | 1/2-3/8 " | FS02410021 | 24 | | 22 | 14 |
| GLV | 1/2-3/8 " | FG02410021 | | | | |
| SYH | 3/4-3/8 " | FS02410031 | 26 | | 36 | 17 |
| GLV | 3/4-3/8 " | FG02410031 | | | | |
| SYH | 3/4-1/2 " | FS02410032 | 26 | | 30 | 13 |
| GLV | 3/4-1/2 " | FG02410032 | | | | |
| SYH | 1-3/8 " | FS02410041 | 29 | | 38 | 19 |
| GLV | 1-3/8 " | FG02410041 | | | | |
| SYH | 1-1/2 " | FS02410042 | 29 | | 38 | 16 |
| GLV | 1-1/2 " | FG02410042 | | | | |
| SYH | 1-3/4 " | FS02410043 | 29 | | 38 | 14 |
| GLV | 1-3/4 " | FG02410043 | | | | |
| SYH | 1 1/4-1/2 " | FS02410052 | 31 | | 46 | 18 |
| GLV | 1 1/4-1/2 " | FG02410052 | | | | |
| SYH | 1 1/4-3/4 " | FS02410053 | 31 | | 46 | 16 |
| GLV | 1 1/4-3/4 " | FG02410053 | | | | |
| SYH | 1 1/4-1 " | FS02410054 | 31 | | 46 | 16 |
| GLV | 1 1/4-1 " | FG02410054 | | | | |
| SYH | 1 1/2-1/2 " | FS02410062 | 31 | | 50 | 18 |
| GLV | 1 1/2-1/2 " | FG02410062 | | | | |
| SYH | 1 1/2-3/4 " | FS02410063 | 31 | | 50 | 16 |
| GLV | 1 1/2-3/4 " | FG02410063 | | | | |
| SYH | 1 1/2-1 " | FS02410064 | 31 | | 50 | 14 |
| GLV | 1 1/2-1 " | FG02410064 | | | | |
| SYH | 1 1/2-1 1/4 " | FS02410065 | 31 | | 50 | 12 |
| GLV | 1 1/2-1 1/4 " | FG02410065 | | | | |
| SYH | 2-1/2 " | FS02410072 | 35 | 48 | 65 | 35 |
| GLV | 2-1/2 " | FG02410072 | | | | |
| SYH | 2-3/4 " | FS02410073 | 35 | 48 | 65 | 33 |
| GLV | 2-3/4 " | FG02410073 | | | | |
| SYH | 2-1 " | FS02410074 | 35 | | 65 | 20 |
| GLV | 2-1 " | FG02410074 | | | | |
| SYH | 2-1 1/4 " | FS02410075 | 35 | | 65 | 18 |
| GLV | 2-1 1/4 " | FG02410075 | | | | |
| SYH | 2-1 1/2 " | FS02410076 | 35 | | 64 | 18 |
| GLV | 2-1 1/2 " | FG02410076 | | | | |
| SYH | 2 1/2-1 " | FS02410084 | 40 | 54 | 80 | 37 |
| GLV | 2 1/2-1 " | FG02410084 | | | | |
| SYH | 2 1/2-1 1/4 " | FS02410085 | 40 | 54 | 80 | 35 |
| GLV | 2 1/2-1 1/4 " | FG02410085 | | | | |
| SYH | 2 1/2-1 1/2 " | FS02410086 | 40 | | 80 | 21 |
| GLV | 2 1/2-1 1/2 " | FG02410086 | | | | |
| SYH | 2 1/2-2 " | FS02410087 | 40 | | 80 | 16 |
| GLV | 2 1/2-2 " | FG02410087 | | | | |
| SYH | 3-1 " | FS02410094 | 44 | 59 | 96 | 42 |
| GLV | 3-1 " | FG02410094 | | | | |
| SYH | 3-1 1/4 " | FS02410095 | 44 | 59 | 97 | 40 |
| GLV | 3-1 1/4 " | FG02410095 | | | | |
| SYH | 3-1 1/2 " | FS02410096 | 44 | 59 | 97 | 40 |
| GLV | 3-1 1/2 " | FG02410096 | | | | |
| SYH | 3-2 " | FS02410097 | 44 | | 97 | 20 |
| GLV | 3-2 " | FG02410097 | | | | |
| SYH | 3-2 1/2 " | FS02410098 | 44 | | 97 | 17 |
| GLV | 3-2 1/2 " | FG02410098 | | | | |
| SYH | 4-2 " | FS02410007 | 51 | 69 | 122 | 46 |
| GLV | 4-2 " | FG02410007 | | | | |
| SYH | 4-2 1/2 " | FS02410008 | 51 | 69 | 122 | 42 |
| GLV | 4-2 1/2 " | FG02410008 | | | | |
| SYH | 4-3 " | FS02410009 | 51 | | 122 | 21 |
| GLV | 4-3 " | FG02410009 | | | | |

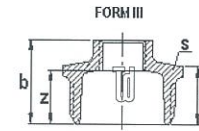
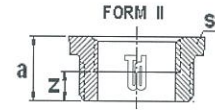
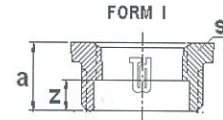

245

ISO/EN(N8)

Nipel
Redüksiyon

Hexagon nipple

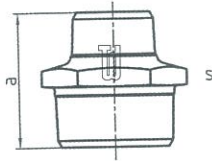

| | Ölçü Size | Kod Code | Poşet Bag | Kutu Carton | Gr Gr |
|-----|---------------|-------------|--------------|----------------|----------|
| SYH | 1/2-3/8 " | FS02450021 | 10 | 450 | 55 |
| GLV | 1/2-3/8 " | FG02450021 | 10 | 450 | 56 |
| SYH | 3/4-1/2 " | FS02450032 | 10 | 250 | 102 |
| GLV | 3/4-1/2 " | FG02450032 | 10 | 250 | 105 |
| SYH | 1-1/2 " | FS02450042 | 10 | 150 | 166 |
| GLV | 1-1/2 " | FG02450042 | 10 | 150 | 172 |
| SYH | 1-3/4 " | FS02450043 | 10 | 150 | 165 |
| GLV | 1-3/4 " | FG02450043 | 10 | 150 | 168 |
| SYH | 1 1/4-1/2 " | FS02450052 | | 100 | 228 |
| GLV | 1 1/4-1/2 " | FG02450052 | | 100 | 237 |
| SYH | 1 1/4-3/4 " | FS02450053 | | 100 | 246 |
| GLV | 1 1/4-3/4 " | FG02450053 | | 100 | 250 |
| SYH | 1 1/4-1 " | FS02450054 | 10 | 100 | 294 |
| GLV | 1 1/4-1 " | FG02450054 | 10 | 100 | 305 |
| SYH | 1 1/2-3/4 " | FS02450063 | | 90 | 540 |
| GLV | 1 1/2-3/4 " | FG02450063 | | 90 | 548 |
| SYH | 1 1/2-1 " | FS02450064 | 10 | 90 | 263 |
| GLV | 1 1/2-1 " | FG02450064 | 10 | 90 | 276 |
| SYH | 1 1/2-1 1/4 " | FS02450065 | | 90 | 279 |
| GLV | 1 1/2-1 1/4 " | FG02450065 | | 90 | 280 |
| SYH | 2-1 " | FS02450074 | | 45 | 397 |
| GLV | 2-1 " | FG02450074 | | 45 | 410 |
| SYH | 2-1 1/4 " | FS02450075 | | 45 | 522 |
| GLV | 2-1 1/4 " | FG02450075 | | 45 | 541 |
| SYH | 2-1 1/2 " | FS02450076 | | 45 | 540 |
| GLV | 2-1 1/2 " | FG02450076 | | 45 | 550 |
| SYH | 2 1/2-2 " | FS02450087 | | 20 | 961 |
| GLV | 2 1/2-2 " | FG02450087 | | 20 | 991 |
| SYH | 3-2 " | FS02450097 | | 15 | 1.296 |
| GLV | 3-2 " | FG02450097 | | 15 | 1.314 |
| SYH | 3-2 1/2 " | FS02450098 | | 15 | 1.390 |
| GLV | 3-2 1/2 " | FG02450098 | | 15 | 1.405 |
| SYH | 4-3 " | FS02450009 | | 10 | 1.060 |
| GLV | 4-3 " | FG02450009 | | 10 | 1.072 |

| | Ölçü Size | Kod Code | a | s |
|-----|---------------|-------------|----|-----|
| SYH | 1/2-3/8 " | FS02450021 | 44 | 22 |
| GLV | 1/2-3/8 " | FG02450021 | | |
| SYH | 3/4-1/2 " | FS02450032 | 47 | 30 |
| GLV | 3/4-1/2 " | FG02450032 | | |
| SYH | 1-1/2 " | FS02450042 | 53 | 36 |
| GLV | 1-1/2 " | FG02450042 | | |
| SYH | 1-3/4 " | FS02450043 | 53 | 36 |
| GLV | 1-3/4 " | FG02450043 | | |
| SYH | 1 1/4-1/2 " | FS02450052 | 57 | 50 |
| GLV | 1 1/4-1/2 " | FG02450052 | | |
| SYH | 1 1/4-3/4 " | FS02450053 | 57 | 46 |
| GLV | 1 1/4-3/4 " | FG02450053 | | |
| SYH | 1 1/4-1 " | FS02450054 | 57 | 46 |
| GLV | 1 1/4-1 " | FG02450054 | | |
| SYH | 1 1/2-3/4 " | FS02450063 | 59 | 60 |
| GLV | 1 1/2-3/4 " | FG02450063 | | |
| SYH | 1 1/2-1 " | FS02450064 | 59 | 50 |
| GLV | 1 1/2-1 " | FG02450064 | | |
| SYH | 1 1/2-1 1/4 " | FS02450065 | 59 | 50 |
| GLV | 1 1/2-1 1/4 " | FG02450065 | | |
| SYH | 2-1 " | FS02450074 | 68 | 65 |
| GLV | 2-1 " | FG02450074 | | |
| SYH | 2-1 1/4 " | FS02450075 | 68 | 65 |
| GLV | 2-1 1/4 " | FG02450075 | | |
| SYH | 2-1 1/2 " | FS02450076 | 68 | 65 |
| GLV | 2-1 1/2 " | FG02450076 | | |
| SYH | 2 1/2-2 " | FS02450087 | 75 | 90 |
| GLV | 2 1/2-2 " | FG02450087 | | |
| SYH | 3-2 " | FS02450097 | 83 | 100 |
| GLV | 3-2 " | FG02450097 | | |
| SYH | 3-2 1/2 " | FS02450098 | 83 | 100 |
| GLV | 3-2 1/2 " | FG02450098 | | |
| SYH | 4-3 " | FS02450009 | 94 | 130 |
| GLV | 4-3 " | FG02450009 | | |

| | Ölçü Size | Kod Code | Poşet Bag | Kutu Carton | Gr Gr |
|-----|--------------|-------------|--------------|----------------|----------|
| SYH | 1/2-3/8 " | FS02460021 | 10 | 300 | 75 |
| GLV | 1/2-3/8 " | FG02460021 | 10 | 300 | 80 |
| SYH | 3/4-1/2 " | FS02460032 | 10 | 180 | 110 |
| GLV | 3/4-1/2 " | FG02460032 | 10 | 180 | 114 |
| SYH | 1-1/2 " | FS02460042 | 10 | 100 | 162 |
| GLV | 1-1/2 " | FG02460042 | 10 | 100 | 175 |
| SYH | 1 1/2-1 " | FS02460064 | | 60 | 335 |
| GLV | 1 1/2-1 " | FG02460064 | | 60 | 344 |

| | Ölçü Size | Kod Code | a | z |
|-----|--------------|-------------|----|----|
| SYH | 1/2-3/8 " | FS02460021 | 43 | 30 |
| GLV | 1/2-3/8 " | FG02460021 | | |
| SYH | 3/4-1/2 " | FS02460032 | 48 | 33 |
| GLV | 3/4-1/2 " | FG02460032 | | |
| SYH | 1-1/2 " | FS02460042 | 55 | 38 |
| GLV | 1-1/2 " | FG02460042 | | |
| SYH | 1 1/2-1 " | FS02460064 | 63 | 44 |
| GLV | 1 1/2-1 " | FG02460064 | | |



246
ISO/DIN (M4)

Maşon Dış
İç Vidalı

Reducing
sockets
male/female

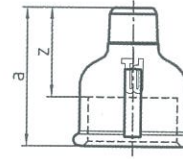

270

ISO/EN (M2)

Manşon Normal

Socket

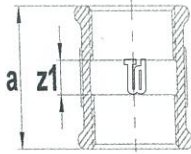

| | Ölçü Size | Kod Code | Po-et Bag | Kutu Carton | Gr Gr |
|-----|--------------|-------------|--------------|----------------|----------|
| SYH | 3/8 " | FS02700001 | 10 | 500 | 56 |
| GLV | 3/8 " | FG02700001 | 10 | 500 | 57 |
| SYH | 1/2 " | FS02700002 | 10 | 370 | 68 |
| GLV | 1/2 " | FG02700002 | 10 | 370 | 73 |
| SYH | 3/4 " | FS02700003 | 10 | 200 | 102 |
| GLV | 3/4 " | FG02700003 | 10 | 200 | 108 |
| SYH | 1 " | FS02700004 | 10 | 140 | 169 |
| GLV | 1 " | FG02700004 | 10 | 140 | 179 |
| SYH | 1 1/4 " | FS02700005 | | 100 | 232 |
| GLV | 1 1/4 " | FG02700005 | | 100 | 253 |
| SYH | 1 1/2 " | FS02700006 | | 70 | 299 |
| GLV | 1 1/2 " | FG02700006 | | 70 | 315 |
| SYH | 2 " | FS02700007 | | 35 | 432 |
| GLV | 2 " | FG02700007 | | 35 | 443 |
| SYH | 2 1/2 " | FS02700008 | | 24 | 734 |
| GLV | 2 1/2 " | FG02700008 | | 24 | 761 |
| SYH | 3 " | FS02700009 | | 15 | 1.029 |
| GLV | 3 " | FG02700009 | | 15 | 1.064 |
| SYH | 4 " | FS02700000 | | 7 | 2.342 |
| GLV | 4 " | FG02700000 | | 7 | 2.370 |

| | Ölçü Size | Kod Code | a | z1 |
|-----|--------------|-------------|----|----|
| SYH | 3/8 " | FS02700001 | 30 | 10 |
| GLV | 3/8 " | FG02700001 | | |
| SYH | 1/2 " | FS02700002 | 36 | 10 |
| GLV | 1/2 " | FG02700002 | | |
| SYH | 3/4 " | FS02700003 | 39 | 9 |
| GLV | 3/4 " | FG02700003 | | |
| SYH | 1 " | FS02700004 | 45 | 11 |
| GLV | 1 " | FG02700004 | | |
| SYH | 1 1/4 " | FS02700005 | 50 | 12 |
| GLV | 1 1/4 " | FG02700005 | | |
| SYH | 1 1/2 " | FS02700006 | 55 | 17 |
| GLV | 1 1/2 " | FG02700006 | | |
| SYH | 2 " | FS02700007 | 65 | 17 |
| GLV | 2 " | FG02700007 | | |
| SYH | 2 1/2 " | FS02700008 | 74 | 20 |
| GLV | 2 1/2 " | FG02700008 | | |
| SYH | 3 " | FS02700009 | 80 | 20 |
| GLV | 3 " | FG02700009 | | |
| SYH | 4 " | FS02700000 | 94 | 22 |
| GLV | 4 " | FG02700000 | | |

| | Ölçü Size | Kod Code | Poşet Bag | Kutu Carton | Gr Gr |
|-----|--------------|-------------|--------------|----------------|----------|
| SYH | 1" | FS270DT004 | 10 | 140 | 179 |

| | Ölçü Size | Kod Code | a | z1 | G |
|-----|--------------|-------------|----|----|------|
| SYH | 1" | FS270DT004 | 45 | 11 | 1/8" |



270DT

Doğalgaz
Test Manşonu

Socket

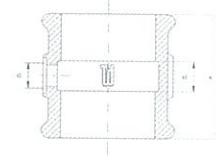

| | Ölçü Size | Kod Code | Poşet Bag | Kutu Carton | Gr Gr |
|-----|--------------|-------------|--------------|----------------|----------|
| SYH | 3/8 " | FS02710001 | 10 | 500 | 58 |
| GLV | 3/8 " | FG02710001 | 10 | 500 | 60 |
| SYH | 1/2 " | FS02710002 | 10 | 370 | 69 |
| GLV | 1/2 " | FG02710002 | 10 | 370 | 72 |
| SYH | 3/4 " | FS02710003 | 10 | 200 | 101 |
| GLV | 3/4 " | FG02710003 | 10 | 200 | 108 |
| SYH | 1 " | FS02710004 | 10 | 140 | 155 |
| GLV | 1 " | FG02710004 | 10 | 140 | 180 |
| SYH | 1 1/4 " | FS02710005 | | 100 | 238 |
| GLV | 1 1/4 " | FG02710005 | | 100 | 250 |
| SYH | 1 1/2 " | FS02710006 | | 70 | 240 |
| GLV | 1 1/2 " | FG02710006 | | 70 | 310 |
| SYH | 2 " | FS02710007 | | 35 | 420 |
| GLV | 2 " | FG02710007 | | 35 | 440 |



271

ISO/EN (M2 R-L)

Manşon
Sağ - Sol

Socket,
Right and
left hand
thread

| | Ölçü Size | Kod Code | a | z1 |
|-----|--------------|-------------|----|----|
| SYH | 3/8 " | FS02710001 | 30 | 10 |
| GLV | 3/8 " | FG02710001 | | |
| SYH | 1/2 " | FS02710002 | 36 | 10 |
| GLV | 1/2 " | FG02710002 | | |
| SYH | 3/4 " | FS02710003 | 39 | 9 |
| GLV | 3/4 " | FG02710003 | | |
| SYH | 1 " | FS02710004 | 45 | 11 |
| GLV | 1 " | FG02710004 | | |
| SYH | 1 1/4 " | FS02710005 | 50 | 12 |
| GLV | 1 1/4 " | FG02710005 | | |
| SYH | 1 1/2 " | FS02710006 | 55 | 17 |
| GLV | 1 1/2 " | FG02710006 | | |
| SYH | 2 " | FS02710007 | 65 | 17 |
| GLV | 2 " | FG02710007 | | |

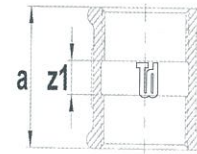

280
ISO/EN (N8)

Nipel

Hexagon nipple

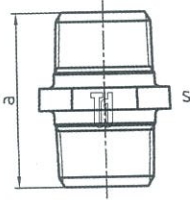

| | Ölçü Size | Kod Code | Poşet Bag | Kutu Carton | Gr Gr |
|-----|--------------|-------------|--------------|----------------|----------|
| SYH | 3/8 " | FS02800001 | 10 | 500 | 44 |
| GLV | 3/8 " | FG02800001 | 10 | 500 | 45 |
| SYH | 1/2 " | FS02800002 | 10 | 400 | 65 |
| GLV | 1/2 " | FG02800002 | 10 | 400 | 67 |
| SYH | 3/4 " | FS02800003 | 10 | 260 | 110 |
| GLV | 3/4 " | FG02800003 | 10 | 260 | 114 |
| SYH | 1 " | FS02800004 | 10 | 150 | 173 |
| GLV | 1 " | FG02800004 | 10 | 150 | 179 |
| SYH | 1 1/4 " | FS02800005 | 10 | 90 | 270 |
| GLV | 1 1/4 " | FG02800005 | 10 | 90 | 296 |
| SYH | 1 1/2 " | FS02800006 | | 70 | 381 |
| GLV | 1 1/2 " | FG02800006 | | 70 | 390 |
| SYH | 2 " | FS02800007 | | 40 | 580 |
| GLV | 2 " | FG02800007 | | 40 | 587 |
| SYH | 2 1/2 " | FS02800008 | | 20 | 847 |
| GLV | 2 1/2 " | FG02800008 | | 20 | 866 |
| SYH | 3 " | FS02800009 | | 15 | 1.197 |
| GLV | 3 " | FG02800009 | | 15 | 1.242 |
| SYH | 4 " | FS02800000 | | 9 | 1.852 |
| GLV | 4 " | FG02800000 | | 9 | 1.900 |

| | Ölçü Size | Kod Code | a | s |
|-----|--------------|-------------|----|-----|
| SYH | 3/8 " | FS02800001 | 38 | 22 |
| GLV | 3/8 " | FG02800001 | | |
| SYH | 1/2 " | FS02800002 | 44 | 27 |
| GLV | 1/2 " | FG02800002 | | |
| SYH | 3/4 " | FS02800003 | 47 | 34 |
| GLV | 3/4 " | FG02800003 | | |
| SYH | 1 " | FS02800004 | 53 | 41 |
| GLV | 1 " | FG02800004 | | |
| SYH | 1 1/4 " | FS02800005 | 57 | 50 |
| GLV | 1 1/4 " | FG02800005 | | |
| SYH | 1 1/2 " | FS02800006 | 59 | 54 |
| GLV | 1 1/2 " | FG02800006 | | |
| SYH | 2 " | FS02800007 | 68 | 69 |
| GLV | 2 " | FG02800007 | | |
| SYH | 2 1/2 " | FS02800008 | 75 | 85 |
| GLV | 2 1/2 " | FG02800008 | | |
| SYH | 3 " | FS02800009 | 83 | 99 |
| GLV | 3 " | FG02800009 | | |
| SYH | 4 " | FS02800000 | 95 | 131 |
| GLV | 4 " | FG02800000 | | |

| | Ölçü Size | Kod Code | Poşet Bag | Kutu Carton | Gr Gr |
|-----|--------------|-------------|--------------|----------------|----------|
| SYH | 3/8 " | FS02900001 | 10 | 500 | 29 |
| GLV | 3/8 " | FG02900001 | 10 | 500 | 31 |
| SYH | 1/2 " | FS02900002 | 10 | 600 | 45 |
| GLV | 1/2 " | FG02900002 | 10 | 600 | 48 |
| SYH | 3/4 " | FS02900003 | 10 | 400 | 71 |
| GLV | 3/4 " | FG02900003 | 10 | 400 | 75 |
| SYH | 1 " | FS02900004 | 10 | 240 | 114 |
| GLV | 1 " | FG02900004 | 10 | 240 | 119 |
| SYH | 1 1/4 " | FS02900005 | 10 | 150 | 177 |
| GLV | 1 1/4 " | FG02900005 | 10 | 150 | 184 |
| SYH | 1 1/2 " | FS02900006 | 10 | 110 | 221 |
| GLV | 1 1/2 " | FG02900006 | 10 | 110 | 232 |
| SYH | 2 " | FS02900007 | | 70 | 377 |
| GLV | 2 " | FG02900007 | | 70 | 392 |
| SYH | 2 1/2 " | FS02900008 | | 30 | 695 |
| GLV | 2 1/2 " | FG02900008 | | 30 | 702 |
| SYH | 3 " | FS02900009 | | 25 | 1.119 |
| GLV | 3 " | FG02900009 | | 25 | 1.131 |
| SYH | 4 " | FS02900000 | | 15 | 1.598 |
| GLV | 4 " | FG02900000 | | 15 | 1.604 |



290
ISO/EN(T9)
Tapa Dış Vidalı
Plug, beaded

| | Ölçü Size | Kod Code | c | s |
|-----|--------------|-------------|----|----|
| SYH | 3/8 " | FS02900001 | 24 | 10 |
| GLV | 3/8 " | FG02900001 | | |
| SYH | 1/2 " | FS02900002 | 27 | 11 |
| GLV | 1/2 " | FG02900002 | | |
| SYH | 3/4 " | FS02900003 | 32 | 17 |
| GLV | 3/4 " | FG02900003 | | |
| SYH | 1 " | FS02900004 | 37 | 18 |
| GLV | 1 " | FG02900004 | | |
| SYH | 1 1/4 " | FS02900005 | 40 | 22 |
| GLV | 1 1/4 " | FG02900005 | | |
| SYH | 1 1/2 " | FS02900006 | 41 | 22 |
| GLV | 1 1/2 " | FG02900006 | | |
| SYH | 2 " | FS02900007 | 48 | 27 |
| GLV | 2 " | FG02900007 | | |
| SYH | 2 1/2 " | FS02900008 | 54 | 32 |
| GLV | 2 1/2 " | FG02900008 | | |
| SYH | 3 " | FS02900009 | 60 | 37 |
| GLV | 3 " | FG02900009 | | |
| SYH | 4 " | FS02900000 | 73 | 41 |
| GLV | 4 " | FG02900000 | | |

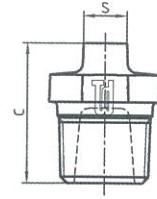

291

ISO/EN (T8)

Tapa Kordonsuz

Plug, plain



| | Ölçü Size | Kod Code | Poşet Bag | Kutu Carton | Gr Gr |
|-----|--------------|-------------|--------------|----------------|----------|
| SYH | 1/2 " | FS02910002 | 10 | 800 | 28 |
| GLV | 1/2 " | FG02910002 | 10 | 800 | 29 |
| SYH | 3/4 " | FS02910003 | 10 | 500 | 54 |
| GLV | 3/4 " | FG02910003 | 10 | 500 | 56 |
| SYH | 1 " | FS02910004 | 10 | 280 | 97 |
| GLV | 1 " | FG02910004 | 10 | 280 | 99 |
| SYH | 1 1/4 " | FS02910005 | 10 | 200 | 125 |
| GLV | 1 1/4 " | FG02910005 | 10 | 200 | 130 |
| SYH | 1 1/2 " | FS02910006 | 10 | 170 | 153 |
| GLV | 1 1/2 " | FG02910006 | 10 | 170 | 140 |
| SYH | 2 " | FS02910007 | | 85 | 306 |
| GLV | 2 " | FG02910007 | | 85 | 317 |
| SYH | 3 " | FS02910009 | | 40 | 679 |
| GLV | 3 " | FG02910009 | | 40 | 682 |
| SYH | 4 " | FS02910000 | | 20 | 1.284 |
| GLV | 4 " | FG02910000 | | 20 | 1.340 |

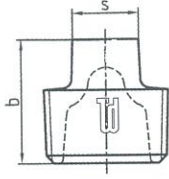

| | Ölçü Size | Kod Code | b | s |
|-----|--------------|-------------|----|----|
| SYH | 1/2 " | FS02910002 | 23 | 11 |
| GLV | 1/2 " | FG02910002 | | |
| SYH | 3/4 " | FS02910003 | 26 | 17 |
| GLV | 3/4 " | FG02910003 | | |
| SYH | 1 " | FS02910004 | 32 | 19 |
| GLV | 1 " | FG02910004 | | |
| SYH | 1 1/4 " | FS02910005 | 32 | 22 |
| GLV | 1 1/4 " | FG02910005 | | |
| SYH | 1 1/2 " | FS02910006 | 33 | 22 |
| GLV | 1 1/2 " | FG02910006 | | |
| SYH | 2 " | FS02910007 | 42 | 27 |
| GLV | 2 " | FG02910007 | | |
| SYH | 3 " | FS02910009 | 46 | 32 |
| GLV | 3 " | FG02910009 | | |
| SYH | 4 " | FS02910000 | 60 | 36 |
| GLV | 4 " | FG02910000 | | |

| | Ölçü Size | Kod Code | Poşet Bag | Kutu Carton | Gr Gr |
|-----|--------------|-------------|--------------|----------------|----------|
| SYH | 1/2 " | FS03000002 | 10 | 400 | 63 |
| GLV | 1/2 " | FG03000002 | 10 | 400 | 65 |
| SYH | 3/4 " | FS03000003 | 10 | 250 | 90 |
| GLV | 3/4 " | FG03000003 | 10 | 250 | 97 |
| SYH | 1 " | FS03000004 | 10 | 190 | 153 |
| GLV | 1 " | FG03000004 | 10 | 190 | 155 |
| SYH | 1 1/4 " | FS03000005 | 10 | 120 | 204 |
| GLV | 1 1/4 " | FG03000005 | 10 | 120 | 207 |
| SYH | 1 1/2 " | FS03000006 | 10 | 110 | 261 |
| GLV | 1 1/2 " | FG03000006 | 10 | 110 | 268 |
| SYH | 2 " | FS03000007 | | 70 | 328 |
| GLV | 2 " | FG03000007 | | 70 | 338 |
| SYH | 2 1/2 " | FS03000008 | | 30 | 869 |
| GLV | 2 1/2 " | FG03000008 | | 30 | 915 |
| SYH | 3 " | FS03000009 | | 25 | 985 |
| GLV | 3 " | FG03000009 | | 25 | 1.028 |
| SYH | 4 " | FS03000000 | | 13 | 1.625 |
| GLV | 4 " | FG03000000 | | 13 | 1.648 |



300
ISO/EN(T1)
Kapak - Tapa
(İç Vidalı)
Cap

| | Ölçü Size | Kod Code | a | s |
|-----|--------------|-------------|----|-----|
| SYH | 1/2 " | FS03000002 | 23 | 26 |
| GLV | 1/2 " | FG03000002 | | |
| SYH | 3/4 " | FS03000003 | 26 | 32 |
| GLV | 3/4 " | FG03000003 | | |
| SYH | 1 " | FS03000004 | 30 | 38 |
| GLV | 1 " | FG03000004 | | |
| SYH | 1 1/4 " | FS03000005 | 33 | 46 |
| GLV | 1 1/4 " | FG03000005 | | |
| SYH | 1 1/2 " | FS03000006 | 36 | 52 |
| GLV | 1 1/2 " | FG03000006 | | |
| SYH | 2 " | FS03000007 | 40 | 62 |
| GLV | 2 " | FG03000007 | | |
| SYH | 2 1/2 " | FS03000008 | 43 | 85 |
| GLV | 2 1/2 " | FG03000008 | | |
| SYH | 3 " | FS03000009 | 45 | 97 |
| GLV | 3 " | FG03000009 | | |
| SYH | 4 " | FS03000000 | 47 | 123 |
| GLV | 4 " | FG03000000 | | |

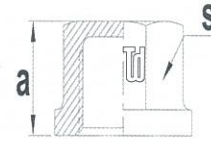

310
ISO/EN (P4)
İnce Somun
Backnut



| | Ölçü Size | Kod Code | Poşet Bag | Kutu Carton | Gr Gr |
|-----|--------------|-------------|--------------|----------------|----------|
| SYH | 1/2 " | FS03100002 | 10 | 900 | 35 |
| GLV | 1/2 " | FG03100002 | 10 | 900 | 40 |
| SYH | 3/4 " | FS03100003 | 10 | 540 | 45 |
| GLV | 3/4 " | FG03100003 | 10 | 540 | 50 |
| SYH | 1 " | FS03100004 | 10 | 300 | 80 |
| GLV | 1 " | FG03100004 | 10 | 300 | 85 |
| SYH | 1 1/4 " | FS03100005 | | 235 | 105 |
| GLV | 1 1/4 " | FG03100005 | | 235 | 110 |
| SYH | 1 1/2 " | FS03100006 | | 200 | 130 |
| GLV | 1 1/2 " | FG03100006 | | 200 | 135 |
| SYH | 2 " | FS03100007 | | 110 | 210 |
| GLV | 2 " | FG03100007 | | 110 | 220 |
| SYH | 2 1/2 " | FS03100008 | | 80 | 340 |
| GLV | 2 1/2 " | FG03100008 | | 80 | 348 |

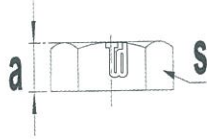

| | Ölçü Size | Kod Code | a | s |
|-----|--------------|-------------|----|----|
| SYH | 1/2 " | FS03100002 | 9 | 32 |
| GLV | 1/2 " | FG03100002 | | |
| SYH | 3/4 " | FS03100003 | 10 | 36 |
| GLV | 3/4 " | FG03100003 | | |
| SYH | 1 " | FS03100004 | 11 | 46 |
| GLV | 1 " | FG03100004 | | |
| SYH | 1 1/4 " | FS03100005 | 12 | 55 |
| GLV | 1 1/4 " | FG03100005 | | |
| SYH | 1 1/2 " | FS03100006 | 13 | 60 |
| GLV | 1 1/2 " | FG03100006 | | |
| SYH | 2 " | FS03100007 | 14 | 75 |
| GLV | 2 " | FG03100007 | | |
| SYH | 2 1/2 " | FS03100008 | 16 | 95 |
| GLV | 2 1/2 " | FG03100008 | | |

| | Ölçü Size | Kod Code | Poşet Bag | Kutu Carton | Gr Gr |
|-----|--------------|-------------|--------------|----------------|----------|
| SYH | 1/2 " | FS03300002 | 10 | 130 | 210 |
| GLV | 1/2 " | FG03300002 | 10 | 130 | 215 |
| SYH | 3/4 " | FS03300003 | 10 | 80 | 325 |
| GLV | 3/4 " | FG03300003 | 10 | 80 | 310 |
| SYH | 1 " | FS03300004 | 10 | 70 | 382 |
| GLV | 1 " | FG03300004 | 10 | 70 | 395 |
| SYH | 1 1/4 " | FS03300005 | | 40 | 605 |
| GLV | 1 1/4 " | FG03300005 | | 40 | 671 |
| SYH | 1 1/2 " | FS03300006 | | 35 | 680 |
| GLV | 1 1/2 " | FG03300006 | | 35 | 749 |
| SYH | 2 " | FS03300007 | | 20 | 995 |
| GLV | 2 " | FG03300007 | | 20 | 1.015 |
| SYH | 2 1/2 " | FS03300008 | | 12 | 1.805 |
| GLV | 2 1/2 " | FG03300008 | | 12 | 1.850 |
| SYH | 3 " | FS03300009 | | 10 | 2.575 |
| GLV | 3 " | FG03300009 | | 10 | 2.630 |

| | Ölçü Size | Kod Code | a | z1 | s1 | s2 | s3 |
|-----|--------------|-------------|----|----|----|-----|----|
| SYH | 1/2 " | FS03300002 | 48 | 22 | 26 | 42 | 26 |
| GLV | 1/2 " | FG03300002 | | | | | |
| SYH | 3/4 " | FS03300003 | 52 | 22 | 31 | 50 | 31 |
| GLV | 3/4 " | FG03300003 | | | | | |
| SYH | 1 " | FS03300004 | 59 | 25 | 38 | 55 | 38 |
| GLV | 1 " | FG03300004 | | | | | |
| SYH | 1 1/4 " | FS03300005 | 65 | 27 | 48 | 68 | 48 |
| GLV | 1 1/4 " | FG03300005 | | | | | |
| SYH | 1 1/2 " | FS03300006 | 70 | 32 | 54 | 75 | 54 |
| GLV | 1 1/2 " | FG03300006 | | | | | |
| SYH | 2 " | FS03300007 | 80 | 30 | 66 | 90 | 65 |
| GLV | 2 " | FG03300007 | | | | | |
| SYH | 2 1/2 " | FS03300008 | 85 | 31 | 83 | 110 | 83 |
| GLV | 2 1/2 " | FG03300008 | | | | | |
| SYH | 3 " | FS03300009 | 95 | 35 | 96 | 130 | 97 |
| GLV | 3 " | FG03300009 | | | | | |



330
ISO/EN(U1)

Düz Rakor

Union,
flat seat

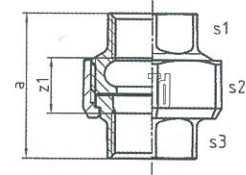

| | Ölçü Size | Kod Code | Poşet Bag | Kutu Carton | Gr Gr |
|-----|--------------|-------------|--------------|----------------|----------|
| SYH | 1/2 " | FS03310002 | 10 | 120 | 242 |
| GLV | 1/2 " | FG03310002 | 10 | 120 | 262 |
| SYH | 3/4 " | FS03310003 | 10 | 80 | 340 |
| GLV | 3/4 " | FG03310003 | 10 | 80 | 359 |
| SYH | 1 " | FS03310004 | | 60 | 436 |
| GLV | 1 " | FG03310004 | | 60 | 405 |
| SYH | 1 1/4 " | FS03310005 | | 35 | 823 |
| GLV | 1 1/4 " | FG03310005 | | 35 | 805 |
| SYH | 1 1/2 " | FS03310006 | | 30 | 878 |
| GLV | 1 1/2 " | FG03310006 | | 30 | 855 |
| SYH | 2 " | FS03310007 | | 15 | 1.295 |
| GLV | 2 " | FG03310007 | | 15 | 1.220 |

| | Ölçü Size | Kod Code | b | z2 | s1 | s2 | s3 |
|-----|--------------|-------------|-----|----|----|----|----|
| SYH | 1/2 " | FS03310002 | 66 | 53 | 26 | 42 | 26 |
| GLV | 1/2 " | FG03310002 | | | | | |
| SYH | 3/4 " | FS03310003 | 72 | 57 | 31 | 50 | 31 |
| GLV | 3/4 " | FG03310003 | | | | | |
| SYH | 1 " | FS03310004 | 80 | 63 | 38 | 55 | 38 |
| GLV | 1 " | FG03310004 | | | | | |
| SYH | 1 1/4 " | FS03310005 | 90 | 71 | 48 | 68 | 47 |
| GLV | 1 1/4 " | FG03310005 | | | | | |
| SYH | 1 1/2 " | FS03310006 | 95 | 76 | 54 | 75 | 53 |
| GLV | 1 1/2 " | FG03310006 | | | | | |
| SYH | 2 " | FS03310007 | 106 | 82 | 66 | 90 | 65 |
| GLV | 2 " | FG03310007 | | | | | |



331
ISO/EN(U2)

Kuyruklu
Düz Rakor

Union,
flat seat

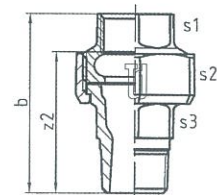

340

ISO/EN(U11)

Konik Rakor

Union,
taper seat

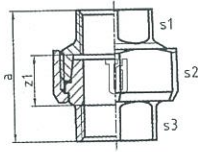

| | Ölçü Size | Kod Code | Poşet Bag | Kutu Carton | Gr Gr |
|-----|--------------|-------------|--------------|----------------|----------|
| SYH | 1/2 " | FS03400002 | 10 | 130 | 211 |
| GLV | 1/2 " | FG03400002 | 10 | 130 | 226 |
| SYH | 3/4 " | FS03400003 | 10 | 80 | 305 |
| GLV | 3/4 " | FG03400003 | 10 | 80 | 321 |
| SYH | 1 " | FS03400004 | 10 | 70 | 349 |
| GLV | 1 " | FG03400004 | 10 | 70 | 359 |
| SYH | 1 1/4 " | FS03400005 | | 40 | 620 |
| GLV | 1 1/4 " | FG03400005 | | 40 | 636 |
| SYH | 1 1/2 " | FS03400006 | | 35 | 666 |
| GLV | 1 1/2 " | FG03400006 | | 35 | 681 |
| SYH | 2 " | FS03400007 | | 20 | 973 |
| GLV | 2 " | FG03400007 | | 20 | 1.009 |
| SYH | 2 1/2 " | FS03400008 | | 12 | 1.597 |
| GLV | 2 1/2 " | FG03400008 | | 12 | 1.654 |
| SYH | 3 " | FS03400009 | | 10 | 2.353 |
| GLV | 3 " | FG03400009 | | 10 | 2.413 |
| SYH | 4 " | FS03400000 | | 4 | 3.138 |
| GLV | 4 " | FG03400000 | | 4 | 3.263 |

| | Ölçü Size | Kod Code | a | z1 | s1 | s2 | s3 |
|-----|--------------|-------------|-----|----|-----|-----|-----|
| SYH | 1/2 " | FS03400002 | 48 | 22 | 26 | 42 | 26 |
| GLV | 1/2 " | FG03400002 | | | | | |
| SYH | 3/4 " | FS03400003 | 52 | 22 | 31 | 50 | 31 |
| GLV | 3/4 " | FG03400003 | | | | | |
| SYH | 1 " | FS03400004 | 58 | 24 | 38 | 55 | 38 |
| GLV | 1 " | FG03400004 | | | | | |
| SYH | 1 1/4 " | FS03400005 | 65 | 27 | 48 | 68 | 48 |
| GLV | 1 1/4 " | FG03400005 | | | | | |
| SYH | 1 1/2 " | FS03400006 | 70 | 32 | 54 | 75 | 54 |
| GLV | 1 1/2 " | FG03400006 | | | | | |
| SYH | 2 " | FS03400007 | 78 | 30 | 65 | 90 | 65 |
| GLV | 2 " | FG03400007 | | | | | |
| SYH | 2 1/2 " | FS03400008 | 85 | 31 | 85 | 110 | 85 |
| GLV | 2 1/2 " | FG03400008 | | | | | |
| SYH | 3 " | FS03400009 | 95 | 35 | 95 | 130 | 95 |
| GLV | 3 " | FG03400009 | | | | | |
| SYH | 4 " | FS03400000 | 110 | 38 | 122 | 150 | 122 |
| GLV | 4 " | FG03400000 | | | | | |

| | Ölçü Size | Kod Code | Poşet Bag | Kutu Carton | Gr Gr |
|-----|--------------|-------------|--------------|----------------|----------|
| SYH | 1/2 " | FS03410002 | 10 | 120 | 225 |
| GLV | 1/2 " | FG03410002 | 10 | 120 | 244 |
| SYH | 3/4 " | FS03410003 | 10 | 80 | 320 |
| GLV | 3/4 " | FG03410003 | 10 | 80 | 335 |
| SYH | 1 " | FS03410004 | | 60 | 403 |
| GLV | 1 " | FG03410004 | | 60 | 416 |
| SYH | 1 1/4 " | FS03410005 | | 35 | 786 |
| GLV | 1 1/4 " | FG03410005 | | 35 | 812 |
| SYH | 1 1/2 " | FS03410006 | | 30 | 812 |
| GLV | 1 1/2 " | FG03410006 | | 30 | 835 |
| SYH | 2 " | FS03410007 | | 15 | 1.220 |
| GLV | 2 " | FG03410007 | | 15 | 1.265 |
| SYH | 2 1/2 " | FS03410008 | | 10 | 1.500 |
| GLV | 2 1/2 " | FG03410008 | | 10 | 2.300 |
| SYH | 3 " | FS03410009 | | 5 | 3.000 |
| GLV | 3 " | FG03410009 | | 5 | 3.089 |
| SYH | 4 " | FS03410000 | | 4 | 4.135 |
| GLV | 4 " | FG03410000 | | 4 | 4.250 |



341

ISO/EN(U12)

Kuyruklu Konik
Rakor

Union,
taper seat

| | Ölçü Size | Kod Code | b | z2 | s1 | s2 | s3 |
|-----|--------------|-------------|-----|-----|-----|-----|-----|
| SYH | 1/2 " | FS03410002 | 66 | 53 | 26 | 42 | 26 |
| GLV | 1/2 " | FG03410002 | | | | | |
| SYH | 3/4 " | FS03410003 | 72 | 57 | 31 | 50 | 31 |
| GLV | 3/4 " | FG03410003 | | | | | |
| SYH | 1 " | FS03410004 | 80 | 63 | 38 | 55 | 38 |
| GLV | 1 " | FG03410004 | | | | | |
| SYH | 1 1/4 " | FS03410005 | 90 | 71 | 48 | 68 | 47 |
| GLV | 1 1/4 " | FG03410005 | | | | | |
| SYH | 1 1/2 " | FS03410006 | 95 | 76 | 54 | 75 | 53 |
| GLV | 1 1/2 " | FG03410006 | | | | | |
| SYH | 2 " | FS03410007 | 106 | 82 | 65 | 90 | 65 |
| GLV | 2 " | FG03410007 | | | | | |
| SYH | 2 1/2 " | FS03410008 | 122 | 95 | 85 | 110 | 85 |
| GLV | 2 1/2 " | FG03410008 | | | | | |
| SYH | 3 " | FS03410009 | 130 | 100 | 95 | 130 | 95 |
| GLV | 3 " | FG03410009 | | | | | |
| SYH | 4 " | FS03410000 | 153 | 117 | 122 | 150 | 120 |
| GLV | 4 " | FG03410000 | | | | | |

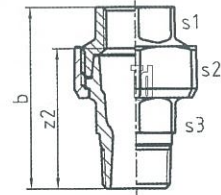

370

Düz Rakor Dişli

Union bush

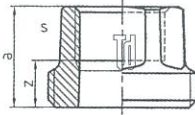

| | Ölçü Size | | Kod Code | Poşet Bag | Kutu Carton | Gr Gr |
|--------------|--------------|---|-------------|--------------|----------------|----------|
| Gew.374 » G« | | | | | | |
| SYH | 1/2 " | 1 | FS03700002 | | 350 | 85 |
| GLV | 1/2 " | 1 | FG03700002 | | 350 | 90 |
| SYH | 3/4 " | 1 | FS03700003 | | 250 | 100 |
| GLV | 3/4 " | 1 | FG03700003 | | 250 | 110 |
| SYH | 1 " | 2 | FS03700004 | | 190 | 135 |
| GLV | 1 " | 2 | FG03700004 | | 190 | 140 |
| SYH | 1 1/4 " | 2 | FS03700005 | | 100 | 215 |
| GLV | 1 1/4 " | 2 | FG03700005 | | 100 | 220 |
| SYH | 1 1/2 " | 2 | FS03700006 | | 80 | 280 |
| GLV | 1 1/2 " | 2 | FG03700006 | | 80 | 285 |
| SYH | 2 " | 3 | FS03700007 | | 50 | 445 |
| GLV | 2 " | 3 | FG03700007 | | 50 | 455 |
| SYH | 2 1/2 " | 4 | FS03700008 | | 30 | 780 |
| GLV | 2 1/2 " | 4 | FG03700008 | | 30 | 810 |
| SYH | 3 " | 4 | FS03700009 | | 20 | 885 |
| GLV | 3 " | 4 | FG03700009 | | 20 | 1000 |

| | Ölçü Size | | Kod Code | a | z | s | |
|--------------|--------------|---|-------------|----|----|----|--------|
| Gew.374 » G« | | | | | | | |
| SYH | 1/2 " | 1 | FS03700002 | 25 | 12 | 26 | 6 köşe |
| GLV | 1/2 " | 1 | FG03700002 | | | | 6 köşe |
| SYH | 3/4 " | 1 | FS03700003 | 28 | 13 | 31 | 6 köşe |
| GLV | 3/4 " | 1 | FG03700003 | | | | 6 köşe |
| SYH | 1 " | 2 | FS03700004 | 31 | 14 | 38 | 6 köşe |
| GLV | 1 " | 2 | FG03700004 | | | | 6 köşe |
| SYH | 1 1/4 " | 2 | FS03700005 | 33 | 14 | 48 | 6 köşe |
| GLV | 1 1/4 " | 2 | FG03700005 | | | | 6 köşe |
| SYH | 1 1/2 " | 2 | FS03700006 | 36 | 17 | 54 | 6 köşe |
| GLV | 1 1/2 " | 2 | FG03700006 | | | | 6 köşe |
| SYH | 2 " | 3 | FS03700007 | 42 | 18 | 66 | 6 köşe |
| GLV | 2 " | 3 | FG03700007 | | | | 6 köşe |
| SYH | 2 1/2 " | 4 | FS03700008 | 46 | 19 | 84 | 8 köşe |
| GLV | 2 1/2 " | 4 | FG03700008 | | | | 8 köşe |
| SYH | 3 " | 4 | FS03700009 | 52 | 22 | 95 | 8 köşe |
| GLV | 3 " | 4 | FG03700009 | | | | 8 köşe |

371

Düz Rakor Nipeli

Union end

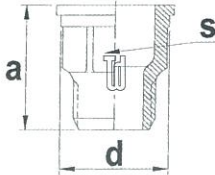

| | Ölçü Size | | Kod Code | Poşet Bag | Kutu Carton | Gr Gr |
|--------------|--------------|---|-------------|--------------|----------------|----------|
| Gew.374 » G« | | | | | | |
| SYH | 1/2 " | 1 | FS03710002 | | 350 | 80 |
| GLV | 1/2 " | 1 | FG03710002 | | 350 | 85 |
| SYH | 3/4 " | 1 | FS03710003 | | 250 | 95 |
| GLV | 3/4 " | 1 | FG03710003 | | 250 | 100 |
| SYH | 1 " | 2 | FS03710004 | | 160 | 150 |
| GLV | 1 " | 2 | FG03710004 | | 160 | 155 |
| SYH | 1 1/4 " | 2 | FS03710005 | | 80 | 330 |
| GLV | 1 1/4 " | 2 | FG03710005 | | 80 | 340 |
| SYH | 1 1/2 " | 2 | FS03710006 | | 75 | 340 |
| GLV | 1 1/2 " | 2 | FG03710006 | | 75 | 355 |
| SYH | 2 " | 3 | FS03710007 | | 40 | 485 |
| GLV | 2 " | 3 | FG03710007 | | 40 | 515 |

| | Ölçü Size | | Kod Code | a | d | s | |
|--------------|--------------|---|-------------|----|------|----|--------|
| Gew.374 » G« | | | | | | | |
| SYH | 1/2 " | 1 | FS03710002 | 40 | 31.8 | 26 | 6 köşe |
| GLV | 1/2 " | 1 | FG03710002 | | | | 6 köşe |
| SYH | 3/4 " | 1 | FS03710003 | 42 | 35.8 | 31 | 6 köşe |
| GLV | 3/4 " | 1 | FG03710003 | | | | 6 köşe |
| SYH | 1 " | 2 | FS03710004 | 47 | 41.3 | 38 | 6 köşe |
| GLV | 1 " | 2 | FG03710004 | | | | 6 köşe |
| SYH | 1 1/4 " | 2 | FS03710005 | 55 | 52.7 | 47 | 6 köşe |
| GLV | 1 1/4 " | 2 | FG03710005 | | | | 6 köşe |
| SYH | 1 1/2 " | 2 | FS03710006 | 58 | 58.7 | 53 | 6 köşe |
| GLV | 1 1/2 " | 2 | FG03710006 | | | | 6 köşe |
| SYH | 2 " | 3 | FS03710007 | 63 | 73.7 | 65 | 6 köşe |
| GLV | 2 " | 3 | FG03710007 | | | | 6 köşe |

| | Ölçü Size | Kod Code | Poşet Bag | Kutu Carton | Gr Gr |
|---------------------|-----------------|--------------|--------------|----------------|----------|
| Gew.374 » G« | | | | | |
| SYH | 1/2 "-1 " | 1 FS0372002A | | 400 | 60 |
| GLV | 1/2 "-1 " | 1 FG0372002A | | 400 | 65 |
| SYH | 1/2 "-1 1/8 " | 1 FS0372002B | | 400 | 60 |
| GLV | 1/2 "-1 1/8 " | 1 FG0372002B | | 400 | 65 |
| SYH | 3/4 "-1 1/4 " | 1 FS0372003C | | 350 | 70 |
| GLV | 3/4 "-1 1/4 " | 1 FG0372003C | | 350 | 80 |
| SYH | 1 "-1 1/2 " | 2 FS0372004D | | 300 | 90 |
| GLV | 1 "-1 1/2 " | 2 FG0372004D | | 300 | 95 |
| SYH | 1 1/4 "-2 " | 2 FS0372005E | | 150 | 165 |
| GLV | 1 1/4 "-2 " | 2 FG0372005E | | 150 | 170 |
| SYH | 1 1/2 "-2 1/4 " | 2 FS0372006F | | 110 | 170 |
| GLV | 1 1/2 "-2 1/4 " | 2 FG0372006F | | 110 | 195 |
| SYH | 2 "-2 3/4 " | 3 FS0372007G | | 70 | 290 |
| GLV | 2 "-2 3/4 " | 3 FG0372007G | | 70 | 305 |
| SYH | 2 1/2 "-3 1/2 " | 4 FS0372008H | | 35 | 545 |
| GLV | 2 1/2 "-3 1/2 " | 4 FG0372008H | | 35 | 560 |
| SYH | 3 "-4 " | 4 FS0372009J | | 25 | 655 |
| GLV | 3 "-4 " | 4 FG0372009J | | 25 | 675 |



372
Düz Rakor
Faturalı
Union end

| | Ölçü Size | Kod Code | a | d | z | s |
|---------------------|-----------------|--------------|----|-------|----|----|
| Gew.374 » G« | | | | | | |
| SYH | 1/2 "-1 " | 1 FS0372002A | 22 | 27.1 | 7 | 26 |
| GLV | 1/2 "-1 " | 1 FG0372002A | | | | |
| SYH | 1/2 "-1 1/8 " | 1 FS0372002B | 21 | 31.8 | 9 | 26 |
| GLV | 1/2 "-1 1/8 " | 1 FG0372002B | | | | |
| SYH | 3/4 "-1 1/4 " | 1 FS0372003C | 22 | 35.8 | 7 | 31 |
| GLV | 3/4 "-1 1/4 " | 1 FG0372003C | | | | |
| SYH | 1 "-1 1/2 " | 2 FS0372004D | 25 | 41.3 | 8 | 38 |
| GLV | 1 "-1 1/2 " | 2 FG0372004D | | | | |
| SYH | 1 1/4 "-2 " | 2 FS0372005E | 30 | 52.7 | 11 | 48 |
| GLV | 1 1/4 "-2 " | 2 FG0372005E | | | | |
| SYH | 1 1/2 "-2 1/4 " | 2 FS0372006F | 32 | 58.7 | 13 | 54 |
| GLV | 1 1/2 "-2 1/4 " | 2 FG0372006F | | | | |
| SYH | 2 "-2 3/4 " | 3 FS0372007G | 34 | 73.7 | 10 | 65 |
| GLV | 2 "-2 3/4 " | 3 FG0372007G | | | | |
| SYH | 2 1/2 "-3 1/2 " | 4 FS0372008H | 37 | 92.9 | 10 | 83 |
| GLV | 2 1/2 "-3 1/2 " | 4 FG0372008H | | | | |
| SYH | 3 "-4 " | 4 FS0372009J | 41 | 104.7 | 11 | 97 |
| GLV | 3 "-4 " | 4 FG0372009J | | | | |

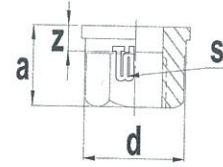

374

Rakor Somunu

Union nut

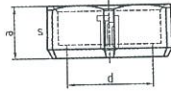

| | Ölçü Size | | Kod Code | Poşet Bag | Kutu Carton | Gr |
|---------------------|-----------------|---|-------------|--------------|----------------|-----|
| Gew.374 » G« | | | | | | |
| SYH | 1/2 "-1 " | 1 | FS037402AS | | 350 | 70 |
| GLV | 1/2 "-1 " | 1 | FG037402AS | | 350 | 75 |
| SYH | 1/2 "-1 1/8 " | 1 | FS037402BS | | 350 | 70 |
| GLV | 1/2 "-1 1/8 " | 1 | FG037402BS | | 350 | 80 |
| SYH | 3/4 "-1 1/4 " | 1 | FS037403CS | | 220 | 125 |
| GLV | 3/4 "-1 1/4 " | 1 | FG037403CS | | 220 | 130 |
| SYH | 1 "-1 1/2 " | 2 | FS037404DS | | 180 | 110 |
| GLV | 1 "-1 1/2 " | 2 | FG037404DS | | 180 | 115 |
| SYH | 1 1/4 "-2 " | 2 | FS037405ES | | 110 | 235 |
| GLV | 1 1/4 "-2 " | 2 | FG037405ES | | 110 | 240 |
| SYH | 1 1/2 "-2 1/4 " | 2 | FS037406FS | | 80 | 210 |
| GLV | 1 1/2 "-2 1/4 " | 2 | FG037406FS | | 80 | 220 |
| SYH | 2 "-2 3/4 " | 3 | FS037407GS | | 60 | 265 |
| GLV | 2 "-2 3/4 " | 3 | FG037407GS | | 60 | 285 |
| SYH | 2 1/2 "-3 1/2 " | 4 | FS037408HS | | 30 | 460 |
| GLV | 2 1/2 "-3 1/2 " | 4 | FG037408HS | | 30 | 480 |
| SYH | 3 "-4 " | 4 | FS037409JS | | 20 | 935 |
| GLV | 3 "-4 " | 4 | FG037409JS | | 20 | 945 |

| | Ölçü Size | | Kod Code | a | d | s | |
|---------------------|-----------------|---|-------------|----|------|-----|--------|
| Gew.374 » G« | | | | | | | |
| SYH | 1/2 "-1 " | 1 | FS037402AS | 18 | 27.5 | 41 | 6 köşe |
| GLV | 1/2 "-1 " | 1 | FG037402AS | | | | 6 köşe |
| SYH | 1/2 "-1 1/8 " | 1 | FS037402BS | 19 | 32 | 42 | 6 köşe |
| GLV | 1/2 "-1 1/8 " | 1 | FG037402BS | | | | 6 köşe |
| SYH | 3/4 "-1 1/4 " | 1 | FS037403CS | 20 | 36 | 50 | 6 köşe |
| GLV | 3/4 "-1 1/4 " | 1 | FG037403CS | | | | 6 köşe |
| SYH | 1 "-1 1/2 " | 2 | FS037404DS | 22 | 41.5 | 55 | 6 köşe |
| GLV | 1 "-1 1/2 " | 2 | FG037404DS | | | | 6 köşe |
| SYH | 1 1/4 "-2 " | 2 | FS037405ES | 24 | 53 | 68 | 8 köşe |
| GLV | 1 1/4 "-2 " | 2 | FG037405ES | | | | 8 köşe |
| SYH | 1 1/2 "-2 1/4 " | 2 | FS037406FS | 25 | 59 | 75 | 8 köşe |
| GLV | 1 1/2 "-2 1/4 " | 2 | FG037406FS | | | | 8 köşe |
| SYH | 2 "-2 3/4 " | 3 | FS037407GS | 27 | 74 | 90 | 8 köşe |
| GLV | 2 "-2 3/4 " | 3 | FG037407GS | | | | 8 köşe |
| SYH | 2 1/2 "-3 1/2 " | 4 | FS037408HS | 30 | 92.5 | 110 | 8 köşe |
| GLV | 2 1/2 "-3 1/2 " | 4 | FG037408HS | | | | 8 köşe |
| SYH | 3 "-4 " | 4 | FS037409JS | 31 | 105 | 130 | 8 köşe |
| GLV | 3 "-4 " | 4 | FG037409JS | | | | 8 köşe |

| | Ölçü Size | Kod Code | Poşet Bag | Kutu Carton | Gr Gr |
|-----|--------------|-------------|--------------|----------------|----------|
| SYH | 1/2 " | FS529A0002 | 10 | 350 | 76 |
| GLV | 1/2 " | FG529A0002 | 10 | 350 | 79 |
| SYH | 3/4 " | FS529A0003 | 10 | 200 | 105 |
| GLV | 3/4 " | FG529A0003 | 10 | 200 | 106 |
| SYH | 1 " | FS529A0004 | 10 | 150 | 150 |
| GLV | 1 " | FG529A0004 | 10 | 150 | 172 |

| | Ölçü Size | Kod Code | a | z |
|-----|--------------|-------------|----|----|
| SYH | 1/2 " | FS529A0002 | 43 | 30 |
| GLV | 1/2 " | FG529A0002 | | |
| SYH | 3/4 " | FS529A0003 | 48 | 33 |
| GLV | 3/4 " | FG529A0003 | | |
| SYH | 1 " | FS529A0004 | 55 | 38 |
| GLV | 1 " | FG529A0004 | | |



529a

ISO/EN (M4)
Manşon
(İç-Dış Dişli)

Extension socket

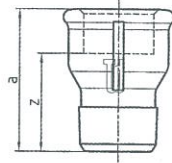

| | Ölçü Size | Kod Code | H | H1 | s1 | G | R |
|-----|--------------|-------------|----|----|----|-----|-----|
| SYH | 1 " | FS330SB0006 | 68 | 57 | 46 | 1 " | 1 " |



330 SB

Sayaç
Bağlama
Rakoru ve
Somunu

Sayaç Bağlama
Rakoru ve Somunu

Union

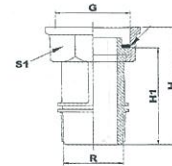

| | Ölçü Size | Kod Code | Poşet Bag | Kutu Carton | Gr Gr |
|-----|--------------|-------------|--------------|----------------|----------|
| SYH | 1 - 1 1/2 " | FS330PB0004 | | 150 | 270 |
| SYH | 1 1/4 - 2 " | FS330PB0005 | | 100 | 400 |

| | Ölçü Size | Kod Code | a | z | s2 | s3 |
|-----|--------------|-------------|----|----|----|----|
| SYH | 1 - 1 1/2 " | FS330PB0004 | 39 | 17 | 55 | 38 |
| SYH | 1 1/4 - 2 " | FS330PB0005 | 44 | 19 | 68 | 48 |



330 PB

Pompa
Bağlama
Rakoru ve
Somunu

Pompa Bağlama
Rakoru ve Somunu

Union

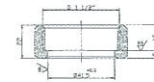

Kutu ölçülerimiz 36 x 24 x 21 cm. dir.

- The size of boxes is 36 x 24 x 21 cm.



Ambalaj sistemimiz 80x120 cm ebadındaki palet üzerine yerleştirilmiş her biri 36x24x21 cm boyutlarında 36 kutudan oluşmaktadır.

Bu katalogdaki fiyat ve parça ağırlık değerleri sadece genel amaçlı olup nominal değerlerdir. Teknik sebeplerden dolayı parça ağırlıkları değişebilir. Trakya Döküm daha önceden bilgi vermeksizin bu katalogdaki değerlerde değişiklik yapma hakkını saklı tutar.

Td packaging system consists of 36 boxes measuring 36 x 24 x 21 cm, placed on a pallet measuring 80 x 120 cm.

- The index and piece weight values in this catalogue are for general purposes only. The piece weights given are nominal values. Differences in piece weights can occur due to technical reasons. Trakya Döküm reserves the right to make changes in values of this catalogue without providing any information beforehand.

TÜRK STANDARLARI ENSTİTÜSÜ
TÜRK STANDARLARINA UYGUNLUK BELGESİ
TURKISH STANDARDS INSTITUTION
CERTIFICATE OF CONFORMITY TO TURKISH STANDARDS

Markanın Tanımı / Description of the Mark
TSE **10918**

BELEGE NUMARASI / REFERENCE NUMBER OF LICENCE: 14.10.2012/TS-744
 BELGENİN İLK VERİŞİ TARİHİ / DATE OF FIRST ISSUE OF LICENCE: 23.05.1985
 BELGENİN SON GEÇERLİLİK TARİHİ / LICENCE VALID UNTIL: 23.05.2013
 BELGE SAHİBİ KURULUŞUN ADI / NAME OF THE LICENCE HOLDER: TRAKYA DÖKÜM SAN. VE TİC. A.Ş.
 İPTAL EDİLEN BELGE NUMARASI (Yerine) / INDICATION OF SUPERSEDED LICENCE (if any): BÜYÜKÖRE ÇADDESİ SOYAK BİNASI NO.38 KAT 2 MEDİCEYKÖY İSTANBUL
 ÖRETMEN YERİ ADI / ADDRESS OF THE MANUFACTURING PLACE: TRAKYA DÖKÜM SAN. VE TİC. A.Ş.
 İPTAL EDİLEN BELGE NUMARASI (Yerine) / INDICATION OF SUPERSEDED LICENCE (if any): İSTANBUL, EDİRNE KARAYOLU ÜZERİNDE BÜYÜKAKARŞIRAN KÖYÜ LÜLEBURGAZ KIRKARELİ
 İZLEN DEĞERİ / SCOPE OF LICENCE: TS 11 EN 10242 / 26.04.2000

14.05.2012
 M. AKIN
 MAKİNA SEKTÖRÜ BELGELENDİRME MÜDÜRÜ

TÜRK STANDARLARI ENSTİTÜSÜ
TÜRK STANDARLARINA UYGUNLUK BELGESİ
TURKISH STANDARDS INSTITUTION
CERTIFICATE OF CONFORMITY TO TURKISH STANDARDS

Markanın Tanımı / Description of the Mark
TSE **10918**

BELEGE NUMARASI / REFERENCE NUMBER OF LICENCE: 14.10.2012/TS-744
 BELGENİN İLK VERİŞİ TARİHİ / DATE OF FIRST ISSUE OF LICENCE: 23.05.1985
 BELGENİN SON GEÇERLİLİK TARİHİ / LICENCE VALID UNTIL: 23.05.2013
 BELGE SAHİBİ KURULUŞUN ADI / NAME OF THE LICENCE HOLDER: TRAKYA DÖKÜM SAN. VE TİC. A.Ş.
 İPTAL EDİLEN BELGE NUMARASI (Yerine) / INDICATION OF SUPERSEDED LICENCE (if any): BÜYÜKÖRE ÇADDESİ SOYAK BİNASI NO.38 KAT 2 MEDİCEYKÖY İSTANBUL
 ÖRETMEN YERİ ADI / ADDRESS OF THE MANUFACTURING PLACE: TRAKYA DÖKÜM SAN. VE TİC. A.Ş.
 İPTAL EDİLEN BELGE NUMARASI (Yerine) / INDICATION OF SUPERSEDED LICENCE (if any): İSTANBUL, EDİRNE KARAYOLU ÜZERİNDE BÜYÜKAKARŞIRAN KÖYÜ LÜLEBURGAZ KIRKARELİ
 İZLEN DEĞERİ / SCOPE OF LICENCE: TS 11 EN 10242 / 26.04.2000

14.05.2012
 M. AKIN
 MAKİNA SEKTÖRÜ BELGELENDİRME MÜDÜRÜ

KALİTE YÖNETİM SİSTEMİ BELGESİ
QUALITY MANAGEMENT SYSTEM CERTIFICATE
EK / ANNEX

Partner of **IONet**

Belge No / Certificate No: KY-008-02/KG-9189-R
 Belgeyi Kuruluş Adı, Adresi / Name and Address of the certified organization: TRAKYA DÖKÜM SAN. VE TİC. A.Ş. BÜYÜKAKARŞIRAN MEYDANI LÜLEBURGAZ 39150 KIRKARELİ / TÜRKİYE

Belge Kapsamı / TS EN ISO 9001:2008
 - HAM VE HELENİŞİ OLARAK GELİŞTİRİLMİŞ TEMPER DÖKÜM PARÇASI
 - TEMPER DÖKÜM BORU EKLEME PARÇALARI
 ÖRETMENİ: MALLEABLE CAST IRON PIPE FITTING

K - Q TSE-ISO-EN 9000

14.07.2009
 TS EN ISO 9001:2008
 PRODUCTION OF
 - GREY, PEUTLE AND BLACKHART M/AS ROUGH AND MACHINED PARTS
 - MALLEABLE CAST IRON PIPE FITTING

РОССИЙСКАЯ ФЕДЕРАЦИЯ
СЕРТИФИКАТ СООТВЕТСТВИЯ
(обязательная сертификация)

№ **СТ.РА.23.В.02750**
 (номер сертификата соответствия)

Заявитель / Applicant: «Тракья Дöküm Санayi ve Ticaret A.Ş.»
 Адрес: Буyükакарширан Меьдеси 39150 Лüleбургаз Кйрканели, Турция

Исполнитель / Manufacturer: «Тракья Дöküm Санayi ve Ticaret A.Ş.»
 Адрес: Буyükакарширан Меьдеси 39150 Лüleбургаз Кйрканели, Турция

Орган по сертификации / Certification Body: «ТРАКЯ ДÖKÜM SANAYI VE TİCARET A.Ş.»
 Адрес: Буyükакарширан Меьдеси 39150 Лüleбургаз Кйрканели, Турция

Испытания / Tests: Проведены в соответствии с требованиями Технического регламента «О безопасности машин и оборудования» (Постановление Правительства РФ от 15.09.2009г. № 753)

Срок действия сертификата соответствия / Validity of the certificate: с 27.10.2011 по 26.10.2012

Эксперт (эксперты) / Expert: К.С. Дубовицкий

TÜV
 TÜV Rheinland / Berlin-Brandenburg

CERTIFICATE
TRAKYA DÖKÜM SAN VE TİC A.S.

in
 Büyükkarışiran

has evidenced, that the company is able to produce threaded pipe fittings according to EN 10242 subject to design symbol A, in accordance with the TÜV Rheinland Substances Prospectus for Fittings in malleable cast iron, Edition 7/99.

Cologne, 28. Juli 1998

Dpl.-Ing F.-J. Steinborn
 Zentralabteilung Werkstoffe und Verarbeitung

KALİTE YÖNETİM SİSTEMİ BELGESİ
QUALITY MANAGEMENT SYSTEM CERTIFICATE

Partner of **IONet**

TÜRK STANDARLARI ENSTİTÜSÜ
 bu belge ile TRAKYA DÖKÜM SAN. VE TİC. A.Ş. BÜYÜKAKARŞIRAN MEYDANI LÜLEBURGAZ 39150 KIRKARELİ / TÜRKİYE

K - Q TSE-ISO-EN 9000

has a QUALITY MANAGEMENT SYSTEM which fulfills the requirements of the TS EN ISO 9001:2008

Belge kapsamı EK'ye verilmiştir / Scope of the certificate is given in annex

TÜRK STANDARLARI ENSTİTÜSÜ
TURKISH STANDARDS INSTITUTION

Sistem Belgelendirme Müdürü / Head of System and Personnel Certification Department: M. AKIN
 Personel ve Sistem Belgelendirme Merkezi Başkanı / Head of Personnel and System Certification Department: M. AKIN

Belge No / Certificate No: KY-008-02/KG-9189-R
 Belge Tarihi / Date of Certificate: 14.07.2009
 Geçerlilik Tarihi / Valid Until: 14.07.2012

Türk Standards Institution, has been accredited by the Turkish Accreditation Agency TÜRKAK.



ekpaş[®]
ekpas.com.tr

EKPAŞ EKLEME PARÇALARI TİCARETİ A.Ş.

Ortaklar Cad. Bahçeler Sk. No:14 Soyak Binası
Mecidiyeköy 34387 İstanbul
Tel: (0212) 315 53 00 pbx Faks: (0212) 274 41 00 - 274 41 06
www.ekpas.com.tr - e-mail: ekpasinfo@ekpas.com.tr

EKPAŞ bir **SOYAK** HOLDİNG kuruluşudur.

